

Richmond Region Tourism's

MEETING PROFESSIONALS *GUIDE*



MeetRichmondVa.com



Unforgettable Events

Happen at the Science Museum of Virginia.



Call 804.864.1400 for details. www.smv.org

Special thanks to our premier partner: **Virginia529**
College Savings Plan

©SEAN DEWITT PHOTOGRAPHY



CAPITAL ALE • HOUSE

LARGEST SELECTION OF VIRGINIA CRAFT BEER • LOCALLY INSPIRED FOOD
CATERING & SPORTS TEAM BANQUETS • FAMILY FRIENDLY ATMOSPHERE



Richmond

623 East Main St
Richmond, VA 23219

Innsbrook

4024-A Cox Road
Glen Allen, VA 23060

Midlothian

13831 Village Place Dr
Midlothian, VA 23114

Also, visit us in Historic Downtown Fredericksburg and Historic Downtown Harrisonburg!

804-780-ALES • CAPITALALEHOUSE.COM

A GREAT MEETING OF MINDS.

We know that whatever its size, your meeting needs to be a big success. Working with over 13,000 square feet of flexible meeting space and a creative culinary staff, our certified Crowne Plaza Meetings Director will ensure that your event is executed flawlessly.



Meetings Service
EXCELLENCE



CROWNE PLAZA®
RICHMOND DOWNTOWN

+1.804.788.0900

WWW.CPRICHMOND.COM

555 EAST CANAL STREET, RICHMOND, VA 23219

©2015 InterContinental Hotels Group. All rights reserved.

**FOUR
POINTS**
BY SHERATON



Four Points by Sheraton Richmond



Four Points by Sheraton Richmond Airport

MEETINGS DONE RIGHT

Two great hotels, each with more than 11,000 square feet of flexible event space. Four Points by Sheraton Richmond and Four Points by Sheraton Richmond Airport can accommodate your group with ease, providing the perfect space for your wedding, banquet, social event or meeting.

Four Points by Sheraton Richmond Enjoy a beautiful backdrop for your next event. The largest of our nine flexible meeting spaces is 4,000 square feet and can accommodate up to 550 guests.

Four Points by Sheraton Richmond

LEARN MORE AT FOURPOINTS.RICHMOND.COM

OR CALL 804 323 1144

Four Points by Sheraton Richmond Airport Stay minutes from the airport. The largest of our eight flexible meeting spaces is nearly 3,000 square feet and can accommodate up to 325 guests.

Four Points by Sheraton Richmond Airport

LEARN MORE AT FOURPOINTS.RICHMONDAIRPORT.COM

OR CALL 804 226 4300

spg.
Starwood
Preferred
Guest

©2015 Starwood Hotels & Resorts Worldwide, Inc. All Rights Reserved. Preferred Guest, SPG, Four Points and their logos are the trademarks of Starwood Hotels & Resorts Worldwide, Inc., or its affiliates. For full terms and conditions, visit fourpointsrichmond.com and fourpointsrichmondaairport.com



Table of Contents

Meeting Professionals Guide

ABOUT RICHMOND

- 4 Welcome
- 6 Why Richmond
- 8 Accessibility
- 10 Wine and Dine
- 12 Attendee Experience
- 14 Itinerary Ideas
- 16 Team Approach

MEETING FACILITIES

- 18 Convention Facilities
- 25 Offsite Venues
- 28 Unique Venues
- 37 Hotel Facilities
- 52 Hotel Map
- 53 Hotel Index
- 58 Attractions Map

*A view of the Richmond skyline
from the Manchester Bridge*



Richmond Region Tourism is the official destination marketing and tourism organization for the counties of Chesterfield, Hanover, Henrico and New Kent, and the City of Richmond.

Call or visit our website today for additional convention and meeting information or to submit a request for proposal. A destination expert will be happy to help you plan your Richmond Region event!



Richmond Region Tourism
401 N. Third Street
Richmond, VA 23219

804.782.2777 or
1.888.RICHMOND
Fax: 804.780.2577

MeetRichmondVa.com

© Richmond Region 2015, Meeting Professionals Guide. This publication may not be reproduced in whole or part in any form or by any means without written permission from the publisher. Publisher is not responsible for errors or omissions. The listings and advertisements in this publication do not imply any endorsement by the publisher or Richmond Region Tourism. Printed in Richmond, Va., by Cadmus Communications, a Cenveo company. Published for the Richmond Region Tourism by Target Communications Inc.

Editor - Nicole Cohen
Art Director - Sarah Lockwood
Cover Photo - Special thanks to The Boathouse at Rocketts Landing for allowing us to shoot on location. Photo by Chris Smith.

For advertising information, questions or comments, contact Rich Malkman, Target Communications Inc., 2201 W. Broad St., Suite 105, Richmond, VA 23220-2022, 804.355.0111.



WELCOME //

Come for the meeting-friendly venues but stay for the arts, entertainment and gourmet dining.

The Richmond Region's blend of big-city excitement with small-town charm is guaranteed to create a lasting impression on your attendees.

Our world-class museums, exquisite art, elegant and modern architecture, distinctive boutiques, lush gardens, and thriving nightlife are all set against a uniquely historic backdrop. And with more than 700 locally owned restaurants in the area, you're **sure** to find plenty to please your palate.

But you've got an event to plan. Luckily for us (and you!), the Region offers more than 18,000 hotel rooms, the largest convention center in Virginia and an international airport offering about 170 daily nonstop flights. Our variety of accommodations and meeting venues is matched only by the exceptional services we offer.

We're ready to get to work for you and make your next meeting or convention a historic success.

Let's get started!



What's New

The Richmond Region is percolating with new attractions, events and amenities for groups of every size. This year and next, the Region welcomes some outstanding upgrades in attractions, events and amenities. Here are just a few:

- With the completion of the Virginia Capital Trail (a paved pedestrian and cycling trail covering more than 50 miles along the scenic Route 5 corridor between Richmond and Williamsburg) and the UCI Road World Championship bike races being held in Richmond — both in Sept. 2015 — the region has become a **cycling destination**. Tour the area's historic neighborhoods through a Richmond Rides Bicycle Tour (bicycles included) or rent one from the city's Carytown Bicycle Co. or Riverside Outfitters to create your own experience.
- Constructed in 1895, the Leigh Street Armory housed the First Battalion Virginia Volunteers — Virginia's first African-American regiment. Later this year, the armory will become the new home of the **Black History Museum and Cultural Center** of Virginia; its grand opening is slated for Jan. 2016.
- On the grounds of the Virginia Museum of Fine Arts, a **brand-new visitors center** will open in late May 2016. An 1850s Italianate structure, The Robinson House, recognized as a National Historic Landmark, is undergoing renovations to serve not only as a source for information about the Region, but will also provide visitors a historical introduction to Richmond.

WHAT THEY'RE SAYING...



(A) American Express Travel, May 2015. (B) Foreign Direct Investment (FDI) Magazine's North American Cities of the Future 2015/16, April 2015. (C) Forbes.com, January 2015. (D) The Huffington Post, September 2014. (E) U.S. National Bureau of Economic Research, July 2014. (F) Frommer's, 2014 (G) Southern Business & Development, September 2014. (H) MyLife.com, March 2014. (I) Colman Andrews, the co-founder of Saveur magazine, in Departures Magazine, August 2014. (J) Huffington Post, April 2015.



RICHMOND'S GOT IT



State-of-the-Art Facilities With Character

Rest easy knowing the Region is beyond accommodating, with more than 18,000 hotel rooms; dozens of large, state-of-the-art convention spaces; and a wide array of remarkable off-site venues — all nestled seamlessly against a historically hip backdrop. Let's make some history!



Doors Wide Open

International airport with low-cost airlines? Check. Central East Coast location? Check. Less than a day's drive for more than half of the U.S. population? Check. Door's open, come on in!



Great Value

The Region offers a variety of options that make the investment of time, energy and resources worth every penny for you and your attendees. Now that's a return on investment!



A Snapshot

HOTEL ROOMS: 18,000+

CONVENTION CENTER: The Greater Richmond Convention Center is Virginia's largest at 700,000 square feet.

AIRPORT: 8 miles from downtown; 170 daily nonstop flights on domestic, international and low-cost air carriers

DINING: 700+ locally owned restaurants

POPULATION: 1.3 million

HIGHER EDUCATION: Five four-year universities and two two-year institutions

LOCATION: Central East Coast, within one day's drive of half the U.S. population

NEARBY: The Atlantic Ocean; Blue Ridge Mountains; and Washington, D.C. are all within a two-hour drive. Charlottesville, Williamsburg and Fredericksburg are within a one-hour drive.

LOCAL GOVERNMENT: Chesterfield County, City of Richmond, Hanover County, Henrico County and New Kent County



Discover the Unexpected

Whether your attendees have one hour to fill or one day, they will quickly realize this is far more than a mere meeting destination; it's an unexpected experience.



Partner With Us

Our team of destination experts partners with you to promote your meeting and provide enhanced meeting services at no cost to you or your attendees. We're in this together!



TRAVELING IS A BREEZE

Amplify your attendance by hosting your meeting or convention in one of the central-most destinations on the East Coast.

Roadway Access

At the junction of Interstates 64 and 95, the Richmond Region is within a day's drive of half the U.S. population, including major metropolitan areas such as New York City and Atlanta. It's also within a two-hour drive of the Atlantic Ocean, Blue Ridge Mountains and our nation's capital, Washington, D.C.

By Plane

Just 15 minutes from downtown Richmond and eight miles from the city's central business district, Richmond International

Airport (RIC) offers about 170 daily nonstop flights on airlines including American, Delta, JetBlue, Southwest, United, US Airways, and Allegiant. Plus, enjoy a modern, two-level terminal and the airport's Greater Richmond Chamber Business Center, which features meeting space, conference rooms and communications services.

For rides to and from the airport, taxi service at RIC is available from first flight departure to last flight arrival. In addition, James River Transportation provides executive sedan and limousine service to the traveling public. Additional transportation options include nine rental agencies and transit service by the Greater Richmond Transit Company (GRTC). The airport is also capable of accommodating large groups via motorcoach transport.

By Train

The region has three Amtrak stations to get you there by rail. The Northeast Regional offers direct service to Richmond from Newport News; Norfolk; Petersburg; Northern Virginia; Washington, D.C. and cities as far north as Boston. A comfortable and enjoyable way to travel, café cars offer appetizing sandwiches, salads, snacks, and hot and cold beverages, including a variety of wine, beer and soda. Hop in the Quiet Car, where cell phones are silenced and conversation is kept to a minimum. Or take advantage of Business Class, where travelers enjoy extra legroom and a complimentary newspaper. A beverage in the Café Car, with access to conference tables, allows for some pre-arrival business. For more information about Amtrak service visit amtrak.com/virginia.



By Automobile

Whether you're renting a car, hailing a taxi or calling an Uber, the region has you covered when navigating the streets. Locals tout that no matter where you are in the Region, you're only 15-20 minutes away from anywhere you'd like to go.

Rent Some Wheels

Charter services, luxury limousines, wheelchair-accessible transportation and most national car-rental companies operate throughout the Richmond Region. If your attendees lean toward the extreme, they can even rent a motorcycle.

Call a Cab

Taxi services are available throughout the Region, including stands at Richmond International Airport, Greyhound/Trailways terminal, Amtrak stations and hotels. Prices start at a \$2.50 drop rate plus \$2.50 per mile.

Take the Bus

GRTC bus fares start at \$1.50 per rider, with senior citizen and disabled fares just 75 cents on local routes. A convenient Go Card (the equivalent of cash) can be purchased in denominations of \$5, \$10 and \$25.

Book an Uber

Offering a ride connection service, Uber utilizes a smartphone app to match destination seekers with nearby drivers who use their own vehicles. At a base fare of \$1.25 plus 20 cents per minute and \$1.35 per mile, the service is a low-cost option for getting around the region. The app also automatically charges the passenger's credit card on file when the destination is reached, so no cash is necessary. To download the Uber app visit uber.com/cities/richmond.

Fast Facts: RIC

Accommodates more than
3.4 million
per year

Charles
Lindbergh and
The Spirit of St. Louis
were the first official
guests of RIC

Opened in
1927

7
Air carriers
serve RIC:
American, Delta,
JetBlue, Southwest, United,
US Airways, and Allegiant

Free wifi since April
2003, a pioneer
among U.S. airports

WINE & DINE

There's a reason Colman Andrews, co-founder of Saveur magazine, named Richmond the "next great American food city" in Departures Magazine. With more than 700 locally owned restaurants and an expanding craft beer scene the Region has options to suit a variety of tastes.



Mosaic restaurant

Award-Winning Vino

Whether you take a winery tour or just meet up at one of the scenic villas, the Region is home to multiple vineyards with award-winning blends of those signature Virginia grapes. Check out James River Cellars Winery (jamesrivercellars.com), which holds monthly events on its patio that usually include an outdoor wine tasting and live music. Try the Gewürztraminer, the grape on which James River Cellars was founded. An architectural gem, New Kent Winery (newkentwinery.com) was built with reclaimed materials salvaged from structures more than 100 years old. The 17,000-square-foot winery has an elegant and spacious tasting room, large outdoor patios, and lounging porches all offering a majestic view of the surrounding countryside.



New Kent Winery

Artfully Crafted

Richmond is home to numerous craft breweries that offer up an endless assortment of artisan brews. There's Hardywood Park Craft Brewery (hardywood.com), which holds regular events for a fun group experience and produces a range of traditional European ales and lagers in addition to inspired selections such as Gingerbread Stout (a holiday favorite) and Virginia Blackberry. Legend Brewing Company (legendbrewing.com) produces 4,500 barrels a year that are distributed mainly within a three-hour radius of Richmond. With a full-service restaurant including a deck with seating overlooking the James River, Legend is a must-see.

Waterside Dining

When in the "River City," why not indulge in some stellar dining as you take in spectacular views of the James? At the riverside outpost of The Boathouse at Rocketts Landing (boathouseva.com), the high-rise outdoor patio mixes modern design with locally sourced fine dining and breathtaking atmosphere. Head over to the Riverfront Canal Walk to enjoy Casa del Barco's (casadelbarco.com) upscale Mexican fare and enormous selection of more than 130 tequilas while relaxing on the patio overlooking the serene canal.

Masterful Mixology

When looking for a satisfying spirit, indulge in unique creations at numerous fine-dining locales. Head to Richmond's Jackson Ward neighborhood for seasonal selections at The Rogue Gentlemen (theroguegentlemen.com), which received a 2015 Elby Award (the region's restaurant awards presented by Richmond magazine) specifically for their cocktail program. Saison (saisonrva.com), also in Jackson Ward, creates Latin American influenced cocktail masterpieces with rum, tequila and mezcal. Sabai (facebook.com/sabairva), in the museum district, offers a fitting collection of colorful, tiki-influenced, fruity cocktails that are a work of art in themselves.

Nationally Recognized

The fine-dining scene in Richmond is booming — and the rest of the country is taking notice. In 2015, the James Beard Foundation awarded Sally Bell's Kitchen (sallybellskitchen.com) the prestigious America's Classics award. Three chefs received semifinalist recognition in the Mid-Atlantic award category for their culinary prowess: Lee Gregory of The Roosevelt (rooseveltrva.com) and Southbound (southboundrva.com), Peter Chang of Peter Chang China Café (peterchangrva.com), and Dale Reitzer of Acacia Mid-town (acaciarestaurant.com).



*The greenhouse
at Lewis Ginter
Botanical Garden*

Going Green

Being eco-friendly is a standard many of the Region's hotels and meeting facilities — including its convention center — have set for themselves. In fact, many of these venues have been certified Virginia Green as part of a statewide program to reduce the environmental impacts of Virginia's tourism industry. Environmentally friendly in their energy and water conservation as well as recycling efforts, many of our facilities are paving the way for a green revolution in tourism.



THE BENEFITS

You and your attendees can save money and protect the environment by reserving space at a facility that balances customer service and a commitment to the planet. Take the Greater Richmond Convention Center, for example, which provides recycling services, has eliminated Styrofoam and reduces disposable waste, conserves water and energy, and supports green conferences and events. It also offers one of the most versatile, technologically advanced conference venues in the state and is Virginia Green-certified. Learn more at visitrichmondva.com/where-to-stay/greenhotels.

Check out our free meetings services on page 17.

Free Admission

Entry into these attractions won't cost your attendees a dime.

Beth Ahabah Museum and Archives
Canal Walk
Chimborazo Medical Museum
Cold Harbor Battlefield Visitor Center
Courtney Road Service Station
Deep Run Schoolhouse
Eppington Plantation
First Freedom Center
Fort Harrison Visitor Center
Gaines' Mill Battlefield
Glendale/Malvern Hill Battlefields Visitor Center
Hanover Courthouse
Historic Polegreen Church
Hollywood Cemetery
The Fed Experience
The James River
Maggie L. Walker National Historical Site
Maymont
Meadow Farm Museum
Monument Avenue
Museum Galleries at Virginia Union University
Museum in Memory of Virginia E. Randolph
Museum of Virginia Catholic History
Museum of Virginia Golf History
The National Donor Memorial
New Kent Courthouse Square
Richmond National Battlefield Park Civil War Visitor Center
Richmond Railway Museum
Rockwood Nature Center
St. John's Church
St. Paul's Episcopal Church
Sixth Mount Zion Baptist Church
Three Lakes Nature Center
Virginia Historical Society
Virginia Holocaust Museum
Virginia Museum of Fine Arts
Virginia Capitol and Executive Mansion
Virginia War Memorial
Walkerton Tavern

Facility rentals are independent of admissions.



EXTRAORDINARY EXPERIENCES

Your attendees will be equally surprised and delighted at all there is to do, see and devour in the Richmond Region. Some visitors may want to enjoy a stroll through our lush gardens, explore the endless retail options, or strap in for a tree-climbing class, but your group may have other ideas. We present Richmond from a variety of perspectives to match the Region's many offerings to your group's idea of an unforgettable visit.

Outdoor Adventurers

Named “Best River Town in America” by Outside magazine and one of the top three Best Outdoor Cities by Blue Ridge Outdoors, meeting-goers wishing to step out of the boardroom and into some board shorts have plenty of options. The James River provides water-related fun such as paddle boarding, tubing or white-water rafting. Miles of mountain-biking and hiking trails wind along the banks of the James and throughout the Region, while those in search of vertical challenges can climb the Manchester Wall or head to Peak Experiences.

Art Lovers

Art enthusiasts will want to set aside time for the Virginia Museum of Fine Arts, recognized as one of the top 10 comprehensive art museums in the nation. Dozens of independent galleries and studios in the Region feature regional and national work. The Cultural Arts Center at Glen Allen showcases rotating exhibits, while Art Works and Plant Zero feature studio space and offer opportunities for attendees to meet the artists. Keep an eye out for street art around town. The Richmond Mural Project adds as many as 20 new murals each year.

History Buffs

Ever since Patrick Henry uttered the words “give me liberty or give me death,” the Richmond Region has been the site of consequential events. Offer your attendees the chance to experience the trail slaves walked upon arrival in Richmond or the hardships Native Americans encountered at Henricus Historical Park. Schedule a tour of the expansive Virginia State Capitol, designed by Thomas Jefferson in 1785. Plan a cruise along the first U.S. canal system, designed by George Washington. Visit the renovated 18th-century Hanover Tavern or circa-1860s Meadow Farm Museum, where costumed interpreters go about their daily farming activities.



Power Shoppers

Attendees will want to leave room in their suitcases for all the treasures they will find in the Region. The area is home to boutiques, craft shops, art galleries and upscale malls. High-end malls include Short Pump Town Center and Stony Point Fashion Park. The eclectic Carytown area, dubbed Richmond’s “Mile of Style,” offers everything from locally made jewelry and runway fashions to home accessories and vintage toys. Quaint neighborhood shopping districts are scattered throughout the Region and are perfect for meeting-goers to grab that one-of-a-kind item before returning home.

Travelers With Family in Tow

Accompanying families have a variety of activities to enjoy while their loved one is occupied. Uptown Alley offers 38 state-of-the-art bowling lanes, plus a full restaurant and billiards. Kings Dominion has more than 60 rides, shows and attractions, including a 20-acre water park (expanded in 2015) and Planet Snoopy, the world’s largest Peanuts-themed children’s area. The Metro Richmond Zoo’s naturalistic exhibits showcase about 2,000 animals, which include giraffes that can be fed by hand. A recent zoo addition, The Treetop Zoofari Zip Line and Adventure Park, features a course that runs through the trees and over the zoo with a Tarzan swing, log bridges and 16 zip lines. Families visiting Maymont’s Children’s Barn and Nature Center can interact with friendly farm animals before journeying through the gardens.

Uptown Alley





ITINERARY IDEAS

Ready-made and waiting to be explored! We've got itineraries prepared and are happy to customize based on your group's needs and interests. Here's a sampling of itineraries your attendees may enjoy:

The Culinary Delights

With more than 700 locally owned restaurants, plus hands-on cooking schools, homegrown craft brews and award-winning wineries, the Region will tickle your taste buds and provide an amazing culinary experience.

African-American Pioneers

Learn about the important contributions of African-Americans to the history of the nation and the Richmond Region through walking tours, monuments and museums.

Juneteenth freedom celebration



Thrills & Chills

Test the limits on record-breaking rollercoasters, rapids and rides. Paddle, ride, scream and play your way through our parks, where the white water is optional, but highly recommended.

Neighborhood Haunts

Richmond is crawling with haunted neighborhoods, spine-tingling Civil War legends, macabre mansions and curiously eerie events. Skeptical? See for yourself.

Lewis Ginter Botanical Garden



Homes & Gardens

Stroll through more than four centuries of American history in beautifully preserved homes and grounds, where a variety of gardens, architectural styles and elaborate décor are on display year-round.

Lincoln's Final Days

On March 23, 1865, President Abraham Lincoln embarked on what would be his last voyage before his assassination on April 15, 1865. Use your downtime to follow in his footsteps and experience his final journey.

Stride Through Time: A Time Travelers Journey

Grab the family and step into your time machine for a journey through more than 400 years of American history along the Liberty Trail.

Historical Heritage

Learn about the heritage and contributions of those who helped shape our nation in the face of hardships and suffering through walking tours, museums, monuments and more.



VolunTourism

A rapidly expanding trend in the meetings industry, VolunTourism allows meeting-goers the opportunity to give back by participating in a community service project at the host destination. Whether your schedule allows for a few hours or a full day, these local nonprofit organizations, and many others, have volunteer programs suited for groups and offer an ideal team-building environment.



Assist the CARITAS Furniture Bank

FEEDMORE CENTRAL VIRGINIA FOOD BANK:

From meal preparation and packing to food sorting and shelf stocking, attendees can volunteer their time to bring hunger relief to the area's most vulnerable populations. feedmore.org

RICHMOND METROPOLITAN HABITAT FOR HUMANITY:

From working on a build site to working in the ReStore (a retail outlet offering donated building and home improvement supplies), your attendees will help facilitate home ownership and break the cycle of poverty. richmondhabitat.org

UNITED FOR UNOS: Help spread the word about the importance of organ donation and transplantation by partnering with United for UNOS. unitedforunos.org

CARITAS: No availability for an in-person volunteer project? The largest provider of services to the homeless in the Region, CARITAS aims to break the cycle of addiction and homelessness. Donations of gently used household items such as pillows, linens, towels and dishes will be distributed to the formerly homeless community now actively rebuilding their lives. caritasshelter.org

The volunteer opportunities listed here represent just a small sampling of opportunities available in the Region. Volunteer programs and the needs of these organizations are subject to change.



SPECIALIZED MEETING, MARKETING & COMMUNITY SERVICES

At Richmond Region Tourism, we make it our job to be of service. As an extension of your team, we partner with you at every stage of the planning process. At the outset, our team works closely with you to understand the needs and objectives of your meeting and those of your attendees. Then we get to work determining the local service providers and hotel properties that best meet those needs. Once meeting sites have been selected, we put our resources to work for you, strategically leveraging our local network and using promotional resources to maximize attendance. Finally, through our on-site and post-event interactions, we engage your group by providing experience-rich visitor services.

We don't believe in cookie-cutter services because we don't believe any two meetings are the same.

Our goal is simple: We want to help you plan, execute and market your meeting and ensure your group has an unforgettable stay. From providing custom marketing materials and housing solutions, to helping generate media coverage and building microsites, to assisting in the site selection process and post-convention feedback, we are here to be of service to you. After all, it takes more than just the right location to make your event a historic success.



No-Cost Services

Because we are funded by a portion of the lodging tax, Richmond Region Tourism provides free services to anyone planning a meeting in the Richmond Region who has included us in the booking process. Costs are not passed on to meeting attendees, either.



How We Can Help

Here is a sampling of services that includes just some of the ways we can help you plan, promote and execute your meeting in the Richmond Region.

PLAN

- Off-site venues and service provider coordination
- Experiential activities and special events
- Ground transportation and tour guides
- Community service projects

HOUSE

- Room block setup and monitoring

PROMOTE

- Attendance-building marketing programs, resources and tools
- Landing pages and microsites
- Local media relations
- Custom maps and driving directions
- Discount and promotional offers
- Local awareness and preparedness
- Volunteer acquisition
- Social media support

HOST

- Attendee welcome programs
- Access to local elected officials, industry leaders and associations
- Pre- and post-convention meeting assistance
- On-site staffing and volunteers
- Dining reservation services

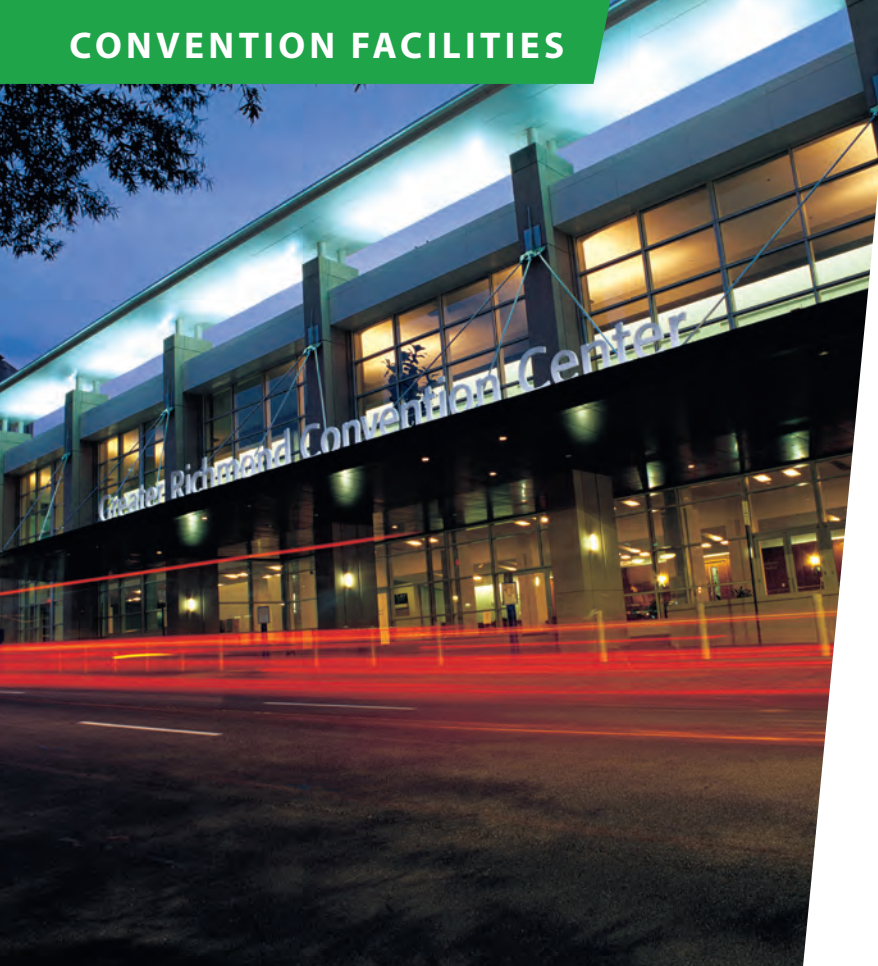

GREATER RICHMOND CONVENTION CENTER

403 N. Third St., Richmond, VA 23219

804.783.7300

richmondcenter.com

The sheer size and central location of the Greater Richmond Convention Center make it one of the most desirable meeting destinations in the mid-Atlantic region. The Center is situated in the heart of downtown Richmond, just minutes from Richmond International Airport. The 700,000-square-foot facility spans 5.5 city blocks and is the ideal location for conventions, business meetings, trade shows, sporting events, banquets and galas.

Boasting 178,159 square feet of contiguous exhibit space, the exhibit hall can be divided into four sections. Exquisitely appointed, the Grand Ballroom features 30,550 square feet of divisible space. Additional features include a Lecture Hall, green room and dressing rooms, a built-in sound system, and flexible lighting with dimming capabilities. Enjoy 50,000 square feet of flexible meeting and breakout rooms to suit all meeting types and needs.

Also located in the building is the Historic Richmond Region Visitor Center and Gift Shop. Should your attendees need additional information about the Richmond Region, travel counselors are happy to oblige with maps, directions, brochures and guides.

For those looking to take home a piece of the Region, the gift shop provides souvenirs of all types.

FAST FACTS:

- 700,000 square feet
- 178,159-square-foot, dividable Exhibit Hall
- 80,000 square feet of additional meeting spaces and presentation rooms, including the Grand Ballroom
- 12,000-square-foot, glassed-in, showroom-style Registration Lobby
- 1,540 covered, attached parking spaces
- 258 fixed classroom-style seats in Lecture Hall
- 650 adjacent hotel rooms and thousands more nearby
- 35-foot ceiling in Exhibit Hall
- 20 truck bays with direct access to Exhibit Halls and Ballroom
- 250-seat Food Court and Lounge overlooking Exhibit Hall floor and Registration Lobby
- Self-operated business Center
- Cyber Café with free Internet access
- State-of-the-art sound systems in all meeting rooms, exhibit halls and ballrooms
- Individual show offices, restrooms and concessions in each Exhibit Hall



GREATER RICHMOND CONVENTION CENTER Meeting Room Specifications

BALLROOM BUILDING - LEVEL I, MEETING ROOMS B10-B19

Meeting Space	Sq. Ft.	Dimensions	Ceiling Height	Theater Seating	Classroom Seating	Banquet Seating
B10	3,232	71' x 44'	11'	258	---	---
B11	1,212	28' x 39'	11'	90	50	50
B12	1,220	28' x 39'	11'	90	50	50
B13	1,220	28' x 39'	11'	90	50	50
B14	982	28' x 31'	11'	70	40	50
B15ABC	7,392	110' x 57'	12'	660	360	320
B15AB	4,802	73' x 57'	12'	435	240	200
B15BC	4,800	73' x 57'	12'	435	240	200
B15A	2,482	37' x 57'	12'	215	112	110
B15B	2,220	36' x 57'	12'	210	108	100
B15C	2,480	37' x 57'	12'	215	112	110
B16	963	28' x 31'	11'	70	40	50
B17	1,200	28' x 39'	11'	90	50	50
B18	1,200	28' x 39'	11'	90	50	50
B19	1,174	28' x 39'	11'	90	50	50

BALLROOM BUILDING - LEVEL II, GRAND BALLROOM B21

Meeting Space	Sq. Ft.	Dimensions	Ceiling Height	Theater Seating	Classroom Seating	Banquet Seating
B20-VIP Suite	1,543	25' x 59'	15'	150	60	80
B21ABC	30,550	132' x 203'	32'	2,750	500	1,600
B21AB	20,167	132' x 135'	32'	1,800	1,000	1,000
B21BC	20,363	132' x 135'	32'	1,800	1,000	1,000
B21A	10,187	132' x 68'	32'	950	500	500
B21B	9,980	132' x 67'	32'	850	450	500
B21C	10,383	132' x 68'	32'	950	500	500

EXHIBIT HALL BUILDING - LEVEL I, EXHIBIT HALL ABCD

Meeting Space	Sq. Ft.	Dimensions	Ceiling Height	Booths 10' x 10'	Booths 12' x 12'	Maximum Occupancy
Exhibit Hall	178,159	274' x 647'	35'	1,115	892	12,186
EH-ABC	136,435	274' x 501'	35'	851	681	9,320
EH-BCD	110,610	274' x 405'	35'	688	550	7,546
EH-AB	101,998	274' x 370'	35'	635	508	6,980
EH-BC	68,886	274' x 248'	35'	426	341	4,680
EH-CD	76,161	274' x 275'	35'	472	378	5,206
EH-A	67,549	274' x 246'	35'	420	335	4,640
EH-B	34,449	274' x 124'	35'	210	168	2,340
EH-C	34,437	274' x 124'	35'	210	168	2,340
EH-D	41,724	274' x 151'	35'	256	205	2,866

GREATER RICHMOND CONVENTION CENTER Meeting Room Specifications

EXHIBIT HALL BUILDING - LEVEL I, MEETING ROOMS E10-E11

Meeting Space	Sq. Ft.	Dimensions	Ceiling Height	Theater Seating	Classroom Seating	Banquet Seating
E10ABCD	7,382	60' x 121'	16'	750	384	360
E10ABC	5,816	60' x 95'	16'	610	320	280
E10BCD	5,180	60' x 86'	16'	560	280	280
E10AB	4,009	60' x 65'	16'	410	210	200
E10CD	3,373	60' x 56'	16'	350	180	160
E10A	2,202	60' x 35'	16'	210	109	100
E10B	1,807	60' x 30'	16'	180	100	80
E10C	1,807	60' x 30'	16'	180	100	80
E10D	1,566	60' x 26'	16'	150	80	80
E11ABC	5,223	60' x 86'	16'	560	280	280
E11AB	3,657	60' x 60'	16'	400	200	200
E11BC	3,373	60' x 56'	16'	350	180	160
E11A	1,850	60' x 30'	16'	180	100	110
E11B	1,807	60' x 30'	16'	180	100	80
E11C	1,566	60' x 26'	16'	150	80	80

EXHIBIT HALL BUILDING - LEVEL II, MEETING ROOMS E20-E25

Meeting Space	Sq. Ft.	Dimensions	Ceiling Height	Theater Seating	Classroom Seating	Banquet Seating
E20	811	18' x 33'; 25' x 25'	28' 8"	80	50	50
E21ABC	5,460	60' x 91'	16'	600	288	280
E21BA	3,900	60' x 60'	16'	400	200	200
E21BC	3,360	60' x 56'	16'	350	180	160
E21A	1,848	60' x 30'	16'	180	100	115
E21B	1,807	60' x 30'	16'	180	100	80
E21C	1,566	60' x 26'	16'	150	80	80
E22AB	1,837	23' x 71'	16'	150	100	100
E22A	1,228	23' x 47'	16'	100	65	60
E22B	609	23' x 24'	16'	50	34	30
E23AB	2,173	23' x 84'	12' 8"	190	110	100
E23A	1,228	23' x 47'	12' 8"	110	70	60
E23B	945	23' x 37'	12' 8"	80	40	40
E24AB	2,173	23' x 84'	12' 8"	190	110	100
E24A	1,228	23' x 47'	12' 8"	100	70	60
E24B	945	23' x 37'	12' 8"	80	40	40
E25AB	2,173	23' x 84'	12' 8"	190	110	100
E25A	1,228	23' x 47'	12' 8"	100	70	60
E25B	945	23' x 37'	12' 8"	80	40	40

GREATER RICHMOND CONVENTION CENTER Floor Plans

Level 1

- Box Office
- Common Area
- Elevators
- Escalators
- Exhibit Hall
- Food Court
- Meeting Rooms
- P Parking
- Restrooms
- Show/Registration Offices and Green Rooms
- Stairs



Hilton Garden Inn

Richmond Marriott



The Richmond Coliseum

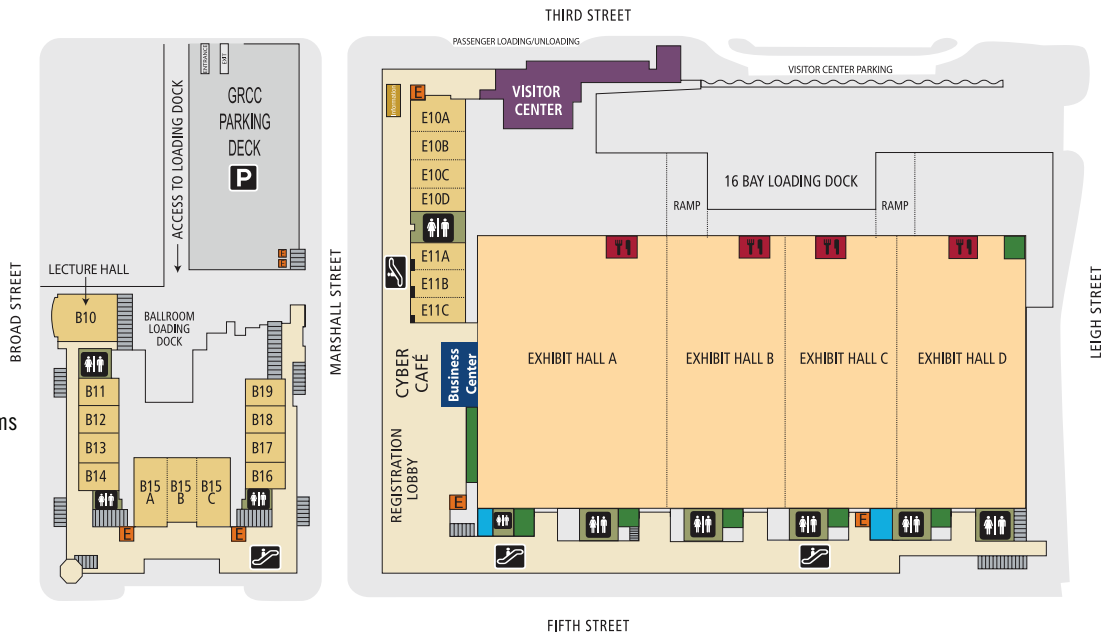

Level 2

- Box Office
- Common Area
- Elevators
- Escalators
- Exhibit Hall
- Food Court
- Meeting Rooms
- P Parking
- Restrooms
- Show/Registration Offices and Green Rooms
- Stairs



Hilton Garden Inn

Richmond Marriott



The Richmond Coliseum

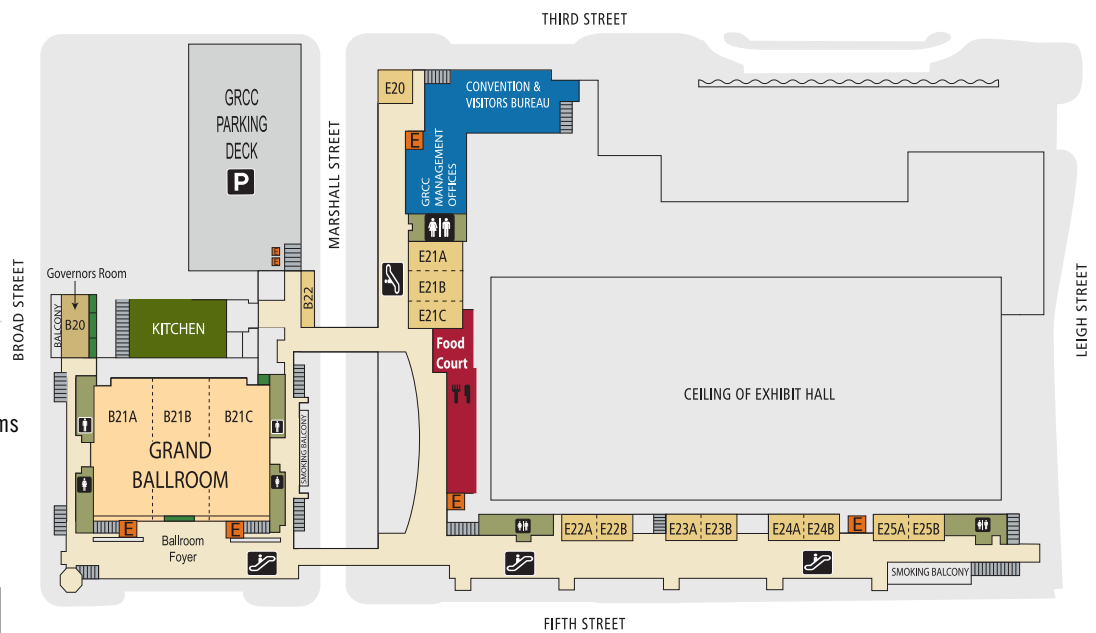



RICHMOND COLISEUM

601 E. Leigh St., Richmond, VA 23219

804.780.4970

richmondcoliseum.net

The Richmond Coliseum features concerts, sporting events and family shows. It is home to the PIFL Richmond Raiders Arena Football team.

For larger events, the Richmond Coliseum is located adjacent to the Greater Richmond Convention Center. The Coliseum offers more than 70,000 square feet of space, as outlined in the chart below, and a 12,217-seat sports and entertainment arena.

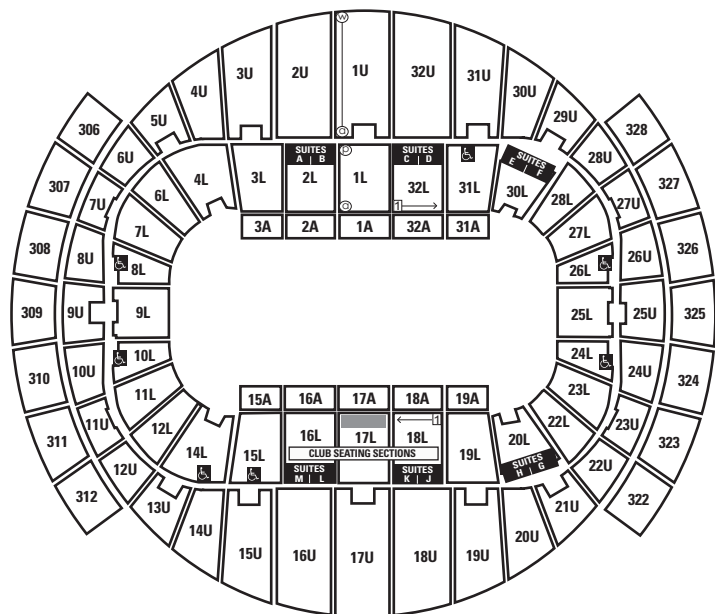

Meeting Space	Sq. Ft.	Dimensions	Banquet	Theater	Classroom	Booth 12' x 12'
Arena	23,760	215' x 107'	3,000	11,330	--	150
Exhibition Halls	50,000	--	--	--	--	--
Club	1,500	--	100	--	--	--
Richmond Room	700	90' x 10'	45	100	--	--
Press Room	800	31' x 26'	--	75	--	--
Team Room (4)	464	24' x 14'	--	30	--	--

RICHMOND RACEWAY COMPLEX

600 E. Laburnum Ave., Richmond, VA 23222

804.228.7506

richmondracewaycomplex.com

Richmond Raceway Complex is a sprawling, 1,000-acre, multipurpose facility that is home to Richmond International Raceway and one of the most versatile special event sites in the country.

The complex has five buildings with more than 150,000 square feet of exhibition and meeting space as well as one of Richmond's most unique venues, the Torque Club. The Torque Club at Richmond International Raceway overlooks the racetrack and makes the perfect setting for corporate, social and nonprofit events. With more than 50 plasma TVs, two built-in bars, a lounge and a view of the racetrack, it is the ideal space to host 20 to 500 people for your next meeting, luncheon or reception. You can make any Torque Club event unforgettable by offering pace car rides around Richmond International Raceway.

The Old Dominion Building is a 36,000-square-foot facility with a 30-foot atrium and beautifully landscaped entrance ideal for large catered affairs, holiday parties and trade shows. In addition to exhibition halls and meeting facilities, the property also has the newly rejuvenated Classic Amphitheater, which offers covered seating for 6,000. Other outdoor venues on the property include the Horticulture Garden and Pavilion.

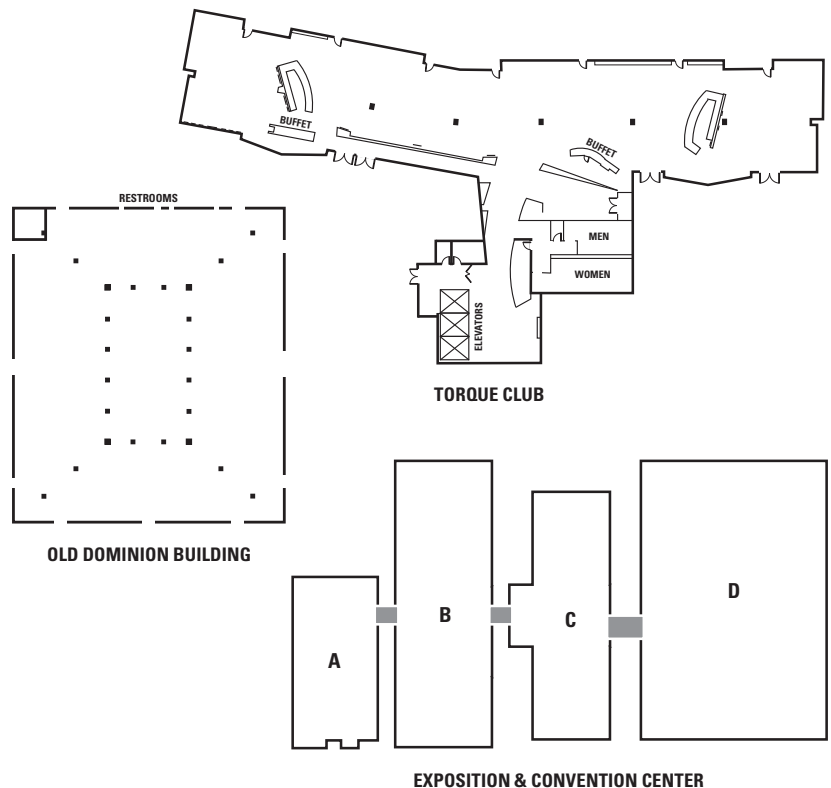

Meeting Space	Sq. Ft.	Dimensions	Reception	Banquet	Theater	Classroom
A – Colonial Building	10,000	140' x 50' x 10'	*	*	*	--
B – Henrico Hall	30,000	300' x 100' x 10'	*	*	*	--
C – Commonwealth Building	20,000	260' x 80' x 10'	*	*	*	--
D – Exhibition Hall	60,000	300' x 190' x 32'	*	*	*	--
Classic Amphitheater	--	--	--	--	6,000	--
Old Dominion Building	36,000	225' x 174' x 30'	*	*	*	--
Torque Club	15,000	--	500	200	150	--

**call for details*



STUART C. SIEGEL CENTER

Virginia Commonwealth University
1200 W. Broad St., Richmond, VA 23284
804.827.1000
siegelcenter.com

The Stuart C. Siegel Center, located on the Monroe Park Campus of Virginia Commonwealth University, is a multipurpose facility that offers flexibility and style for events, athletics and community programs.

The Verizon Wireless Arena at the Siegel Center is a perfect venue to hold a convention, trade show or concert. It can seat up to 7,500 people or offer 38,000 square feet of open floor space.

The Siegel Center also offers meeting space, full-service in-house catering and concessions for its customers. Hospitality suites, which include the Tommy J. West Club and University and Athletic Suites, are available for rental.

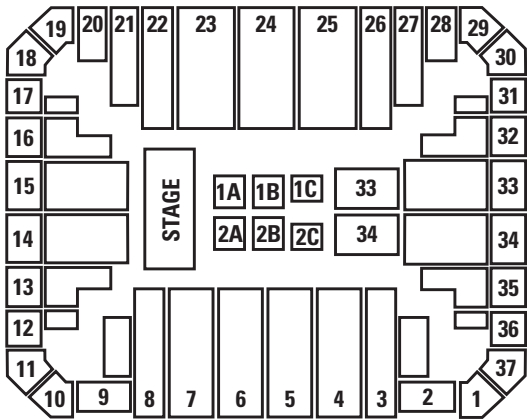
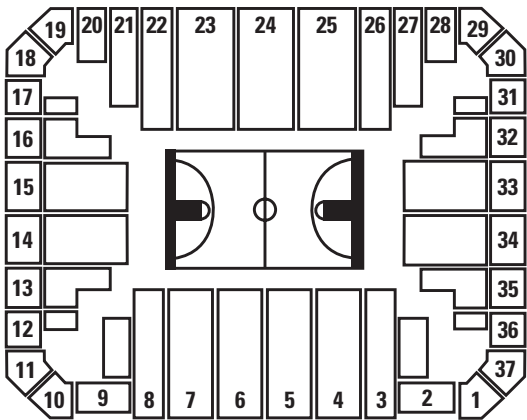

Meeting Space	Sq. Ft.	Reception	Theater	Classroom	Boardroom	Basketball Seats
Verizon Wireless Arena	38,000	--	--	--	--	7,500



ARTHUR ASHE JR. ATHLETIC CENTER

3001-A N. Boulevard, Richmond, VA 23230
804.780.6153

The 38,400-square-foot Arthur Ashe Jr. Athletic Center is a 6,000-seat athletic facility containing a basketball court and indoor track. The center is also available for trade shows.

Capacity: 6,000

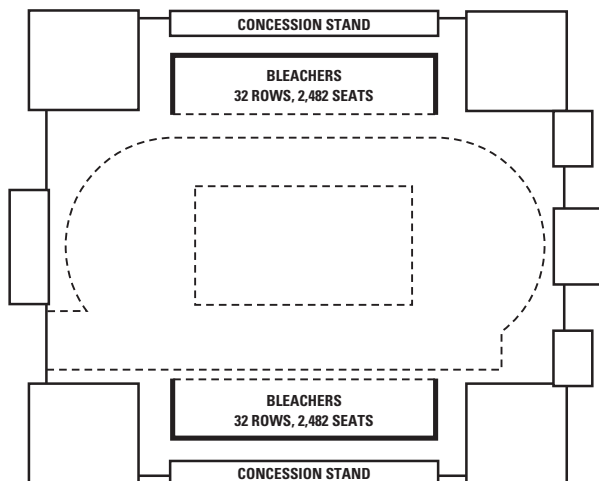

PHOTO BY STEVE HEDBERG

THE NATIONAL

708 E. Broad St., Richmond, VA 23219
804.612.1900
thenationalva.com

The National is a state-of-the-art music venue complete with stage, video screens and monitors, and seven full bars. The balcony features 300 padded, stadium-style seats.

Capacity: 1,500

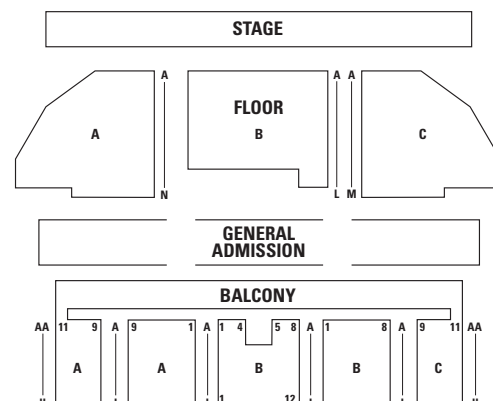

RICHMOND CENTERSTAGE

PHOTO BY GEOFF BURKE



ALTRIA THEATER

A Richmond CenterStage Venue
6 N. Laurel St., Richmond, VA 23220
804.592.3368, altriatheater.com

Not only is the 3,600-seat Altria Theater the largest performance venue between New York and Atlanta, but the 180,000-square-foot complex also houses six lounges and a ballroom for private events.

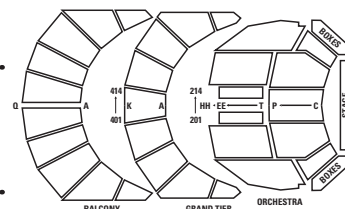

CARPENTER THEATRE

Richmond CenterStage's Downtown Complex
600 E. Grace St., Richmond, VA 23219
804.592.3330, richmondcenterstage.com

Located in the heart of the Arts District, the Carpenter Theatre has a capacity of nearly 1,800 and is listed on the National Register of Historic Places.

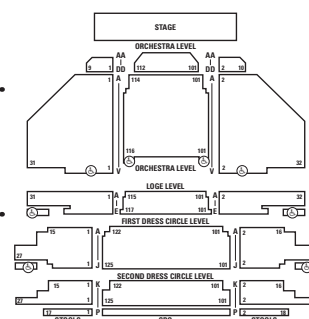

LIBBY S. GOTTWALD PLAYHOUSE

Richmond CenterStage's Downtown Complex
600 E. Grace St., Richmond, VA 23219
804.592.3330, richmondcenterstage.com

The 200-seat Libby S. Gottwald Playhouse is an intimate setting for performances, lectures, conferences and presentations.

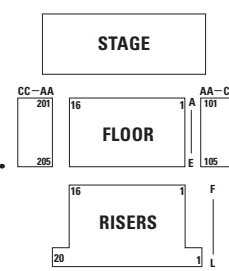

GOTTWALD PLAYHOUSE



RHYTHM HALL

Richmond CenterStage's Downtown Complex
600 E. Grace St., Richmond, VA 23219
804.592.3330, richmondcenterstage.com

Rhythm Hall is a multi-purpose venue that regularly features intimate cabaret performances, stand-up comedy, wedding receptions, corporate luncheons and community gatherings.

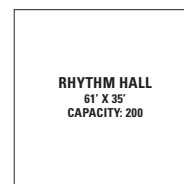

VIRGINIA MUSEUM OF FINE ARTS

200 N. Boulevard, Richmond, VA 23220
804.340.1590
specialevents@vmfa.museum

The Virginia Museum of Fine Arts is an extraordinary venue for meetings and events, offering security, full-service catering and onsite parking. The historic buildings and striking architecture on campus, in combination with the remarkable permanent collection of more than 33,000 works of art, make the museum one of Richmond's greatest cultural assets.

VMFA offers theater-style seating in the Leslie Cheek Theater (472 max.) and in the Reynolds Lecture Hall (150 max.). The multipurpose Claiborne Robertson Room seats 75 for a meal or 60 classroom style. The Conference Center has two conference rooms. Conference Center 1 accommodates 40 and the Founder's Conference Room accommodates up to 30. Additionally, the museum offers spectacular settings for seated dinners up to 300 and receptions up to 1,000.

Capacity: 1,000

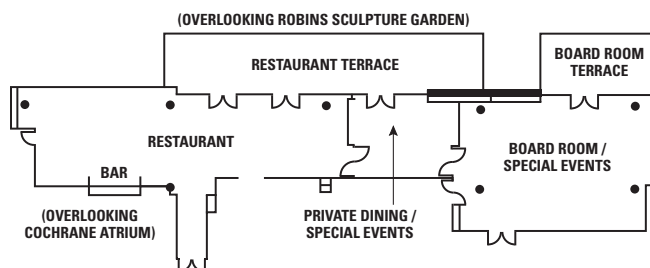

VIRGINIA WAR MEMORIAL

621 S. Belvidere St., Richmond, VA 23220
804.786.2060
vawarmemorial.org

The Virginia War Memorial's 18,000-square-foot Paul and Phyllis Galanti Education Center provides state-of-the-art meeting space in a spectacular setting overlooking the James River and downtown business district. From board meetings to a reception for several hundred indoors or out, the Memorial can accommodate a variety of events.

Indoor venues include the VMI Alumni Hall of Honor, Freedom Hall, McMurtrie Grand Lobby, Reynolds Theater and Schumann Conference Room. Outdoor spaces include the Ukrop Terrace, Grand Terrace and the Heilman Amphitheater. Onsite parking and catering kitchen.

Capacity: 800

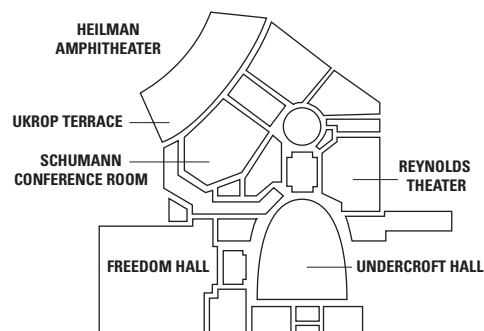

UNIQUE VENUES

Whether you need creative brainstorming sessions, client dinners or collaborative team-building events, finding the right venue is essential to fostering the desired outcome. The Richmond Region offers a wide variety of options, from enchanting historic homes to breathtaking sites along the James River, from airy, hip galleries to lush vineyards.



American Civil War Center

500 Tredegar St., Richmond, VA 23219
804.780.1865
tredegar.org

This 8.3-acre riverfront venue is created from the remnants of Richmond's historic Tredegar Iron Works. The site offers varied options for events, and your attendees can enjoy a riverfront view or visit the Center's flagship exhibit, "In the Cause of Liberty."

Meeting Space	REC	TH	CR	BAN
BlueStone Courtyard	1,000	500	—	500
Brick Courtyard	600	—	—	250
Bluestone Patio	250	150	—	150
Brick Patio	350	225	—	225



Art Works

320 Hull Street Road, Richmond, VA 23224
804.291.1400
artworksrichmond.com

An artful place to hold small or large business meetings, as well as seminars, lectures and banquets, Art Works is located a half-mile from downtown Richmond. It includes facilities for team-building group workshops, as well as projectors, tables and chairs, and a kitchen.

Meeting Space	REC	TH	CR	BAN
Jane Sandelin Gallery	250	300	200	200
All Media Gallery	75	100	75	75
Centre Gallery	30	50	30	30



The Boathouse at Rocketts Landing

4708 E. Old Main St., Richmond, VA 23231
804.622.2628
boathouserichmond.com

The Boathouse offers an array of meeting and event rooms with stunning views of both the Richmond skyline and the James River. Its main floor, with a full bar, is available for events during the daytime.

Meeting Space	REC	TH	CR	BAN
City View	60	—	—	40
River View	230	—	—	150
Harbourmaster Suite	40	—	—	30
Marina View	70	—	—	48
Tented Pavilion	250	—	—	150

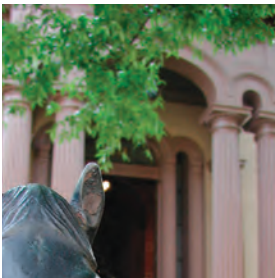

Bolling Haxall House

211 E. Franklin St., Richmond, VA 23219
804.643.2847
twcrichmond.org

The Bolling Haxall House, an Italianate villa in downtown Richmond, offers flexible meeting spaces equipped with modern business necessities. Request a list of preferred caterers; kitchen facilities available.

Meeting Space	REC	TH	CR	BAN
Boardroom	—	—	48	—
Ballroom	250	300	—	250



Bookbinder's Steak & Seafood Restaurant

2306 E. Cary St., Richmond, VA 23223
804.643.6900
bookbindersrichmond.com

Family-owned Bookbinder's offers the perfect combination of history and atmosphere. From intimate dinners for eight to blow-out bashes, the restaurant can accommodate a variety of social and corporate affairs, all completely customized to suit your needs.

Meeting Space	REC	TH	CR	BAN
Taxin Room	15	—	—	15
President's Room	24	—	—	24
Tobacco Row Room	36	—	—	36
Courtyard Room	50	—	—	50
Riverfront Room	70	—	—	70
Entire Restaurant	200	—	—	200

Capital Ale House

(Downtown) 623 E. Main St., Richmond, VA 23219
(Innsbrook) 4024 Cox Road, Glen Allen, VA 23060
(Midlothian) 13831 Village Place Drive, Midlothian VA 23114
804.822.3075
capitalalehouse.com

The Music Hall is a versatile venue perfect for not only music, but everything from corporate events to rehearsal dinners. The Lounge provides space for socializing and mingling as well as a dining room for catering. The Game Room is a bright and open space, great for company dinners or get togethers.

Meeting Space	REC	TH	CR	BAN
Music Hall (Downtown)	300	—	—	230
Game Room (Innsbrook)	80	—	—	30
Lounge (Midlothian)	75	—	—	35



Celebrations at the Reservoir

4801 Woolridge Road, Moseley, VA 23120
804.739.9015
celebrationsva.com

Located on 125 acres near the wooded, upscale subdivisions of Woodlake and Brandermill, Celebrations includes three distinct venues, each with its own staffing and parking, which together can accommodate events of many sizes.

Meeting Space	REC	TH	CR	BAN
Manor House	300	—	—	220
The Azalea Garden	200	—	—	200
Pool Pavilion	250	—	—	175



Children's Museum of Richmond

2626 W. Broad St., Richmond, VA 23220
804.474.7000
c-mor.org

The museum offers a fun-filled setting for meetings. Up to 1,000 guests can occupy the entire museum. Numerous options are available for smaller groups. Request a list of preferred caterers; kitchen facilities available.

Meeting Space	REC	TH	CR	BAN
Entire Museum	1,000	—	—	—
The Backyard	175	50	—	—
Lobby	500	—	—	150
Pavilion	250	150	125	150
Performing Arts	45	35	30	40
Celebration Center	50	25	30	30
Clock Room	50	25	30	30



Crossroads Art Center

2016 Staples Mill Road, Richmond, VA 23230
804.278.8950
crossroadsartcenter.com/banquet.html

No need to decorate this unique party space; the artwork is already on the walls! Crossroads has hundreds of free parking spaces and is wheelchair accessible.

Meeting Space	REC	TH	CR	BAN
Classroom One	75	100	25	60
Classroom Two	35	50	18	30
Rhoda MacCallum Gallery	125	—	—	85
Gallery One	75	40	—	40



PHOTO BY DAVID PROETT

The Cultural Arts Center at Glen Allen

2880 Mountain Road, Glen Allen, VA 23060
804.261.6211
artsglenallen.com

The Center offers a unique arts-oriented setting with both indoor and outdoor spaces available for meetings, trade shows, special events and dinners. With 12 different spaces, The Center can accommodate groups from 20 to 350 people. Special features include a three-room art gallery and a 350-seat theatre.

Meeting Space	REC	TH	CR	BAN
Cardinal Ballroom	300	250	125	225
Glen Allen Room & Forest Lounge	—	—	—	38
Dogwood Salon	90	50	40	70
Kornblau Board Room	—	—	—	20
Grand Ballroom	180	125	80	120
Weinstein Sculpture Garden	200	240	—	160
Gumenick Art Gallery	90	—	—	60
Studio A (Siegel Studio)	80	80	60	60
Studio F	80	75	40	50
Studio G	80	75	40	50
Theatre	—	350	—	—





Cultural Center of India

6641 Ironbridge Parkway, Chester, VA 23831
804.536.2524

ccihall.com Email: vitapansuvia@yahoo.com_mgr

The Cultural Center of India is a 20,000-square-foot facility with a banquet hall, foyer, dining room and kitchen. The facility also has a professional sound system and a main hall with a 2,000-square-foot stage where groups can host performances.

Meeting Space	REC	TH	CR	BAN
Banquet Hall	700	300	—	—



Dominion Club

6000 Dominion Club Drive, Glen Allen, VA 23059
804.360.0095
tdcva.com

A private country club open to nonmembers, this venue offers a variety of event spaces in an elegantly appointed setting with hardwood floors and a spiral staircase. It's located within the Wyndham planned community, with views of a scenic lake.

Meeting Space	REC	TH	CR	BAN
Lower Rotunda	175	—	—	135
Upper Rotunda	125	—	—	80
Private Dining Room	60	65	35	60
Executive Board Room	30	—	20	20
Lakeside Terrace	350	250	—	—



Gallery 5

200 W. Marshall St., Richmond, VA 23220
804.510.0488 Fax: 804.592.5841
gallery5arts.org

Gallery 5, originally a fire and police station, is a Richmond historic landmark. An eclectic space, the venue includes an upstairs ballroom, gallery space, a commercial kitchen, banquet space, a full bar and stage.

Meeting Space	REC	TH	CR	BAN
Entire Venue	300	151	151	151



Ginter Park Women's Club

3016 Seminary Ave., Richmond, VA 23227
804.358.7314

This facility includes an auditorium with stage, two dressing rooms, a sound system and a grand piano, as well as a large foyer, a well-equipped kitchen and a commercial-size stove.

Meeting Space	REC	TH	CR	BAN
Auditorium	200	—	200	200



The Hanover Arts & Activities Center

500 S. Center St., Ashland, VA 23005
804.798.2728
hanoverarts.org

The historic building with soaring windows and ceilings, hardwood floors and a minimalist décor provides a blank canvas to decorate. And you're not limited to the Ballroom. The Neoclassic exterior, expansive front lawn and towering oak trees are a perfect backdrop for an outdoor wedding or event.

Meeting Space	REC	TH	CR	BAN
Center	250	—	—	150
Conference Room	—	—	20	—
Classrooms	—	—	20	—



Hanover Tavern

13181 Hanover Courthouse Road, Hanover, VA 23069
804.537.5050
hanovertavern.org

Located 15 miles north of Richmond, this 200-year-old building provides an excellent space for corporate meetings and special events. Catering provided by the onsite full-service restaurant. Free Wi-Fi also available.

Meeting Space	REC	TH	CR	BAN
Washington Room	12	—	12	12
Arch Room	40	—	40	40
The Veranda	—	—	45	45
Taylor Room	—	—	50	50
The Bradley Theater	—	150	—	—
Brick Terrace	150	—	—	150
Coach House	200	—	—	160

Henricus Historical Park

251 Henricus Park Road, Chester, VA 23836
804.748.1611
henricus.org

The site of the New World's second successful English settlement, Henricus offers a natural woodland setting for meetings. Located about 20 minutes from downtown Richmond, Henricus Historical Park has outdoor and indoor facilities that accommodate up to 250 people. Caterers welcome; kitchen facilities available.

Meeting Space	REC	TH	CR	BAN
Henricus Education Center	—	—	260	75
Mount Malady	—	—	75	—
Executive Board Room	—	—	18	—
James River Bluff	1,000	—	—	—
Tavern	—	—	50	—
Board Room 1	—	—	20	—
Board Room 2	—	—	20	—



The Hippodrome Theater and Mansion

528 and 526 N. Second St., Richmond, VA 23219
804.266.2021
hippodromerichmond.com

The Hippodrome first opened in 1914 as a vaudeville and movie theater in Jackson Ward, while the Taylor Mansion next door, circa 1895, was home to a founder of an African-American-owned bank. In 2010, the two buildings were converted into a new, live music and entertainment venue with a restaurant and retail and residential space.

Meeting Space	REC	TH	CR	BAN
Hippodrome Theater	550	450	—	380
Taylor Mansion	80	—	—	60
Speakeasy	200	—	—	140



PHOTO BY ASH DANIEL

Historic Mankin Mansion

4300 Oakleys Lane, Richmond, VA 23223
804.737.7773
historicmankinmansion.com

A historic marvel, this resort is nestled minutes from downtown Richmond. Professional event planners are on staff to make your event worry-free.

Meeting Space	REC	TH	CR	BAN
Rockefeller Room	50	—	25	50
Tented Pavilion	200	—	200	200

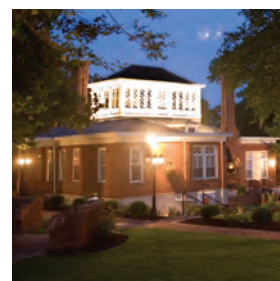

Independence Golf Club

600 Founders Bridge Blvd., Midlothian, VA 23113
804.897.8641
independencegolfclub.com

Located in Midlothian, this newly renovated clubhouse was inspired by Thomas Jefferson's magnificent Monticello estate. The establishment offers a numerous selection of dining options with everything from elegant plated dinners to casual buffets and cocktail receptions. Staging, podium and audiovisual equipment are also available.

Meeting Space	REC	TH	CR	BAN
Ball Room	300	—	250	235
Auditorium	—	—	80	—
Wine Room	50	—	40	40
Tavern 19 Restaurant	100	—	—	90
Fall Line Room	100	—	80	80
Terrace under Awning	40	—	—	35
Open Terrace	80	—	—	50



Iron Horse Restaurant

100 S. Railroad Ave.
804.752.6410
ironhorserestaurant.com

Iron Horse offers several dining options to meet the desires of locals, travelers and destination diners. A welcoming upscale-casual bistro on one hand and an inviting neighborhood pub on the other – both with views of the trains. Iron Horse also features a semi-private dining room for personalized special events.

Meeting Space	REC	TH	CR	BAN
Semi-private dining	—	—	—	30
Entire Restaurant	—	—	—	200



James River Cellars Winery

11008 Washington Highway, Glen Allen, VA 23059
804.550.7516
jamesrivercellars.com

Only 15 minutes from downtown Richmond, James River Cellars Winery hosts corporate events, private parties and fundraisers. The winery offers an event room, outdoor grounds and areas for breakout sessions. Adjacent parking is available, along with flat-screen TVs, wireless Internet, and wine tastings and winery tours.

Meeting Space	REC	TH	CR	BAN
Event Room	40	—	—	—
Patio	—	—	—	—
Lawn	500	—	—	—
Reception Tent	200	—	—	—





The John Marshall Ballrooms

Fifth & Franklin streets, Richmond, VA 23219
804.775.2323
thejohnmarshallballrooms.com

Restored to the grandeur of the 1920s, the grand historic ballrooms include the Marshall Room and the Virginia Room, which has balconies that overlook the ballroom and a grand entry stairway. The Marshall Room has 30-foot ceilings and floor-to-ceiling windows. Catering services provided by John Marshall Catering, a division of Homemades by Suzanne.

Meeting Space	REC	TH	CR	BAN
Virginia Room	500	600	400	350
Marshall Room	200	200	150	175



Lewis Ginter Botanical Garden

1800 Lakeside Ave., Richmond, VA 23228
804.262.9887, ext. 224 or 345
lewisginter.org

The garden offers beautiful facilities for corporate and private events. A fully equipped auditorium is ideal for conferences, seminars and meetings, with space for board meetings or breakout sessions. Other spaces on site offer unique rental options for corporate outings, receptions, dinners and parties. The garden offers an exclusive onsite caterer.

Meeting Space	REC	TH	CR	BAN
Auditorium	325	250	110	176
Partial #3	—	176	60	—
Azalea Room	40	50	30	48
Robins Room	250	—	—	—
Visitors Center	—	—	—	—
Robins Room	125	140	50	136
Café	100	—	—	60
Bloemendaal House	140	—	—	48
Entire Downstairs & Tent	250	—	—	144
Robins Tea House	60	—	—	70



Main Street Station

1500 E. Main St., Richmond, VA 23219
804.523.3328
rmaonline.org

Main Street Station is one of Richmond's most recognizable historic landmarks, with the majestic clock tower greeting travelers from afar. The station offers a space for weddings, receptions, and other private and corporate events. Currently undergoing Shed renovations so please contact 804.523.3328 or mainstreetstation@the-rma.org for availability and booking information.

Meeting Space	REC	TH	CR	BAN
Main Room	200	100	100	100
Smaller Room	—	30	30	—



Maymont

1700 Hampton St., Richmond, VA 23220
804.358.7166
crosenberg@maymont.org

Maymont is a 100-acre American estate, an extraordinary gift given to the community by James and Sallie Dooley. They completed their mansion in 1893 and spent the next three decades creating gardens, landscapes and outbuildings.

Meeting Space	REC	TH	CR	BAN
Garden Hall & Terrace	150	—	—	—
Carriage House Lawn	250+	—	—	—
Nature & Visitor Center	500	—	—	—
Conference Room at Nature Center	—	—	16	—
Robins Room	—	—	40	—
Stone Barn	—	50	—	—



Meadowbrook-Chesdin Country Club

21801 Lake Chesdin Parkway, Chesterfield, VA 23838
804.590.0031
meadowbrookchesdin.com

Situated in the elegance of the Chesdin Landing neighborhood, Meadowbrook-Chesdin Country Club is a premiere trek of 18 holes boasting a contemporary feel complimented by the beauty of its surroundings. Indoor and outdoor spaces can accommodate various groups and events including weddings, bridal showers and receptions.

Meeting Space	REC	TH	CR	BAN
Clubhouse	120	—	—	—
Dining Room	—	—	—	60
Pavillion	100+	—	—	100+



The Place at Innsbrook

4036-C Cox Road, Glen Allen, VA 23060
804.346.2100
theplaceatinnsbrook.com

The Place at Innsbrook professionally manages all weddings, receptions, corporate meetings and special events. The Place features beautiful rooms, an outdoor patio with waterfalls and excellent cuisine and services, with the convenience of hotels and shopping within walking distance.

Meeting Space	REC	TH	CR	BAN
Ballroom	300	400	77	330
Salons	150	200	57	100
Innsbrook Room	45	40	16	24
Garden Room	80	70	36	60
Pavilion Room	50	50	24	40

Plant Zero

0 E. Fourth St., Richmond, VA 23224
804.322.9575
rvaeventspace.com

Plant Zero is a 7,000-square-foot former warehouse turned event site. It has a very urban, artsy atmosphere that can be transformed with each event. Plant Zero has proven to be an exceptional site for wedding receptions, bar mitzvahs, fashion shows, parties, art openings and fundraisers of all sorts.



The Renaissance Conference Center

107 W. Broad St., Suite 300, Richmond, VA 23220
804.649.3373
renaissanceva.com

Previously the Old Masonic Temple, The Renaissance has been magnificently restored to its original Victorian splendor, with grand rooms and extensive amenities including catering and beverage service, onsite parking, and state-of-the-art audiovisual and Internet capabilities.



Richmond Ballet

407 E. Canal St., Richmond, VA 23219
804.344.0906
richmondballet.com

Richmond Ballet has limited studio rental.



Roslyn Conference and Retreat Center

8727 River Road, Richmond, VA 23229
804.288.6045 or 800.477.6296
roslyncenter.org

Roslyn welcomes groups for residential conferences, retreats, meetings and picnics. Located on the western edge of Richmond, Roslyn offers more than 7,900 square feet of quiet, peaceful meeting space overlooking the James River valley. Overnight lodging is available, as well as a dining facility that can accommodate up to 150 guests.



PHOTO BY JESSICA DODDS

Science Museum of Virginia

2500 W. Broad St., Richmond, VA 23220
804.864.1400
smv.org

Set in a restored train station listed on the National Register of Historic Places, this venue has a stimulating environment including indoor and outdoor space and a five-story, domed theater. The museum offers free parking. Request a list of recommended caterers; limited kitchen facilities available.



PHOTO BY MICHAEL WAINE

SunTrust Center

919 E. Main St., Richmond, VA 23213
804.782.5996
suntrustcenter.com

Centrally located in downtown, SunTrust Center offers meeting and special event space. The fourth-floor conference center features several meeting spaces that can accommodate up to 220 guests. The 24th-floor dining room offers panoramic views of the city and is perfect for everything from business luncheons to the most elegant wedding reception.



Meeting Space	REC	TH	CR	BAN
Entire Facility	400	400	400	350

Meeting Space	REC	TH	CR	BAN
Roosevelt Room/Ballroom	450	450	—	300
Grand Foyer	150	—	—	—
Adams Room	115	156	—	100

Meeting Space	REC	TH	CR	BAN
Third-Floor Studio	—	250	—	—

Meeting Space	REC	TH	CR	BAN
Gibson Hall	—	80	50	—
Walker Assembly	—	110	55	—
Walker Lounge	—	25	—	—
Tucker Hall	—	80	50	—
Bishop's Dining Room	—	—	20	—
West Room	—	—	16	—
The Chancellor's Room	—	—	10	—
Dining Hall	—	—	—	150

Meeting Space	REC	TH	CR	BAN
RF&P Forum	150	—	175	100
Rotunda	500	—	—	250
Thalhimer Pavilion	800	900	—	500
Garner Pavilion	1,000+	—	—	1,000+
Discovery Room	125	150	—	80
Mezzanine	200	—	—	—
Dome Theater	—	250	—	—
Ms. Barbara	—	119	—	—
Thalhimer Theater	—	—	—	—

Meeting Space	REC	TH	CR	BAN
Auditorium	—	221	—	—
Piedmont Room	—	—	30	—
Shenandoah Room	—	—	25	—
Tidewater Room	—	—	50	—
Tilghman Room	—	—	20	—
Main Dining	300	—	—	150
Board Room	—	—	35	—
State Planters Room	—	—	30	—
Spotswood	—	—	10	—
Seaboard	—	—	15	—



Swift Creek Mill Theatre

**17401 Jefferson Davis Highway,
Colonial Heights, VA 23834**
804.748.5203
swiftcreekmill.com

Dating to 1663, this historic gristmill has been adapted into a venue ideal for rehearsal dinners and small receptions. There are upper and lower dining spaces and the theater is on the top floor. The venue is listed in the National Register of Historic Places.

Meeting Space	REC	TH	CR	BAN
Mill Room	100	—	130	130
Swift Creek Mill Theatre	220	220	220	—
Granite Room	100	100	140	140



The Tobacco Company Restaurant

1201 E. Cary St., Richmond, VA 23219
804.782.9555
thetobaccocompany.com

The four-story restaurant embodies the spirit of Southern hospitality and charm. Whether you are in search of an exquisite meal in an unforgettable atmosphere or an exclusive club to dance the night away, The Tobacco Company Restaurant can accommodate large and small groups.

Meeting Space	REC	TH	CR	BAN
Private Dining Offices	—	—	8	—
Large Party Dining	—	—	—	150
Victorian Lounge	65	—	—	—
The Tobacco Company Club	250	—	—	—



Tuckahoe Plantation

12601 River Road, Richmond VA 23238
804.971.8329
tuckahoeplantation.com

Tuckahoe Plantation, the boyhood home of Thomas Jefferson, is a privately owned and operated National Historic Landmark. Featuring beautiful gardens and overlooking the James River west of Richmond, Tuckahoe is the perfect place for your event.

Meeting Space	REC	TH	CR	BAN
The Old Stable Building	60	—	—	45
Outdoor Sites	—	—	—	500



The Valentine

1015 E. Clay St., Richmond, VA 23219
804.649.0711
thevalentine.org

We provide a "very Richmond" alternative for your private event. The Valentine is conveniently located in downtown Richmond and offers both indoor and outdoor accommodations.

Meeting Space	REC	TH	CR	BAN
Garden	150	—	—	75
Multi-Purpose Room	150	90	60	75
Stern Gallery/ Conference Room	—	35	30	30
Gray Family Terrace	120	—	—	60



Virginia Aviation Museum

5701 Huntsman Road, Richmond, VA 23250
804.236.3622
vam.smv.org

The Virginia Aviation Museum accommodates receptions, buffets, dinners or meetings in the evening with colorful vintage aircraft as a backdrop. Request a list of caterers. Preparation area available for caterers.

Meeting Space	REC	TH	CR	BAN
J.D. Benn Theater	—	40	40	—
Exhibit Wings	300	—	—	200



Virginia Capitol

10th and Bank streets, Richmond, VA 23219
804.698.1788
virginiacapitol.gov

The restored Virginia State Capitol carries on themes originally presented by Thomas Jefferson and also caters to a 21st-century visitor's expectation of what the Commonwealth's Capitol should be. New working space features many meeting amenities, including public restrooms, meeting rooms, an exhibit gallery, gift shop and café.

Meeting Space	REC	TH	CR	BAN
Senate Room 3	150	125	100	130
House Room 3	150	125	100	130
Rotunda	100	—	—	—
Old Senate Chamber	75	—	—	40
Jefferson Room	75	—	—	40

The Branch Museum of Architecture and Design

2501 Monument Ave., Richmond, VA 23220
804.644.3041
architectureva.org

Host your next special event, meeting, retreat or party at an architectural treasure located on Richmond's historic Monument Avenue. The interior spaces and elegant garden can be arranged to accommodate a variety of events, from sophisticated cocktail parties to daylong corporate retreats.

Meeting Space	REC	TH	CR	BAN
Adam Board Room	30	—	30	30
Georgian Parlor	15	—	—	—
Social Gallery	62	35	30	50
Long Gallery/Great Hall	100	—	60	100
Rooftop Terrace	32	—	—	32
Garden	Call for details.			



Virginia Historical Society

428 N. Boulevard, Richmond, VA 23220
804.342.9676
vahistorical.org

From small and intimate to large and spacious, the meeting and reception spaces at the VHS offer flexible set-up times, A/V equipment, kitchen access for caterers, and can be used for both daytime and evening events.

Meeting Space	REC	TH	CR	BAN
Halsey Lecture Hall	600	300	150	200
Robins Conference Room	21	—	—	24
Robins Forum	—	488	—	—
Weinstein Classroom	—	68	40	—



Virginia Holocaust Museum

2000 E. Cary St., Richmond, VA 23223
804.257.5400
va-holocaust.com

The Virginia Holocaust Museum is suitable for events of all sizes and types. Facilities include a large auditorium with balcony, a 5,300-square-foot classroom and a flexible meeting room, as well as two art galleries. Audiovisual equipment is available.

Meeting Space	REC	TH	CR	BAN
Auditorium	300	300	300	300
TEI Classroom	150	150	75	100
Meeting Room (Old Library)	75	—	75	60
Art Gallery	50	—	—	50



Virginia House

4301 Sulgrave Road, Richmond, VA 23221
804.353.4251
vahistorical.org

Virginia House and its gardens provide a bucolic setting for daytime retreats and corporate receptions. Request a list of preferred caterers; kitchen facilities available.

Meeting Space	REC	TH	CR	BAN
Gallery	—	50	25	40
Great Hall	—	50	25	40
Terrace	80	80	—	50
House & Grounds	80	—	—	—



Visual Arts Center of Richmond

1812 W. Main St., Richmond, VA 23220
804.353.0094
visarts.org

The Visual Arts Center of Richmond offers 30,000 square feet of interior space in the heart of Richmond's historic Fan District. Your event can be enhanced by offering attendees access to a gallery exhibition, and there are also venues for outdoor events.

Meeting Space	REC	TH	CR	BAN
Varies: See website.				



Walkerton Tavern

2892 Mountain Road, Glen Allen, VA 23060
804.261.6898
henricorecandparks.com

Walkerton was built by John Walker between 1824 and 1825. In the course of its history, the structure has served as a tavern, hotel, store, post office and voting precinct. Walkerton Tavern and its gardens host a variety of programs and special events and are available to rent for weddings, conferences and group meetings.

Meeting Space	REC	TH	CR	BAN
First Floor	35	—	—	21
Second Floor	60	—	—	50



PHOTO BY JUSTIN VAUGHAN



Weddings at Wrexham L.L.C.

10301 Old Wrexham Road, Chesterfield, VA 23832
804.768.8000
wrexhamhall.net

This graceful 200-year-old manor has been adapted into a venue that will add charm to any event. Wrexham Hall offers full-service catering and limited bar service. There is a large, glassed-in sunroom and a landscaped garden.

Meeting Space	REC	TH	CR	BAN
Indoor Manor/Garden	200	—	100	120



Wilton House

215 S. Wilton Road, Richmond, VA 23226
804.382.5936
wiltonhousemuseum.org

A historic house located in a residential neighborhood along the James River, Wilton House is ideal for meetings. Up to 175 people can be accommodated in the large lecture hall and terrace, which can be tented. Request a list of caterers; kitchen facilities available.

Meeting Space	REC	TH	CR	BAN
Meeting Room With Terrace	175	125	75	100



The Wine Loft

4035 Whittall Way, Glen Allen, VA 23060
804.368.1768
wineloftrichmond.com

Located at West Broad Village in the heart of Short Pump, the Wine Loft can accommodate a wide range of social gatherings from fundraisers to company parties. Event planners will find The Wine Loft ideal for corporate socials, cocktail parties, receptions, presentations and general after-hours functions.

Meeting Space	REC	TH	CR	BAN
Entire Building	200	—	—	—
Loft	50	—	—	—
Downstairs	120	—	—	—

FEEL LIKE AN INSIDER BEFORE HOSTING YOUR MEETING HERE



12 ISSUES OF
RICHMOND
MAGAZINE

+

6 ISSUES OF
R-HOME

=

FOR ONLY

\$19

TO SUBSCRIBE VISIT:

RICHMONDMAGAZINE.COM/SUBSCRIBE

CROWNE PLAZA RICHMOND DOWNTOWN

555 E. Canal St., Richmond, VA 23219

804.788.0900

crowneplaza.com/ric-downtown

The Crowne Plaza Richmond Downtown overlooks the banks of the James River in the heart of the city's business district.

QUICK STATS

Miles from GRCC

<1

Miles from RIC airport

9

Minutes to closest shops, restaurants

5

Total meeting space (sq. ft.)

13,000

Total rooms/suites

298/29

AMENITIES

- High-speed Internet access in all rooms
- Wheelchair-accessible facilities available
- Business-class floor offering complimentary continental breakfast, hors d'oeuvres and beverages
- Casually elegant dining in the Pavilion Café, serving breakfast, lunch and dinner
- The Great Room Lounge serving cocktails and a light menu
- Indoor swimming pool and onsite fitness center, including whirlpool
- The Pantry, open 24 hours, serving Starbucks
- Complimentary shuttle service within 2-mile radius of hotel
- Certified Crowne Meetings Director to assist with all of your meeting needs

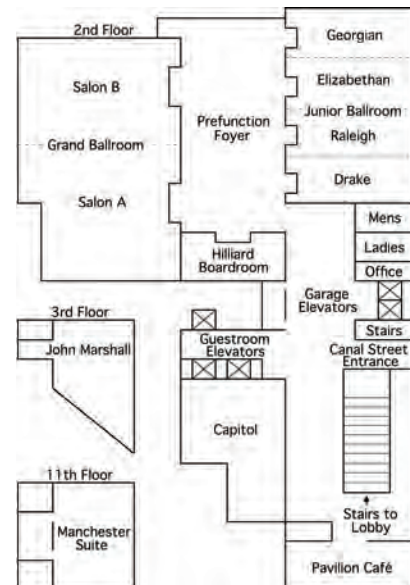

Meeting Space	Sq. Ft.	Dimensions	Reception	Banquet	Theater	Classroom	Conference
Pre-Function	2,250	90' x 25'	200	—	—	—	—
Grand Ballroom	4,085	95' x 43'	500	350	500	280	—
Salon A	1,849	43' x 43'	200	150	200	100	—
Salon B	2,236	52' x 43'	250	200	250	150	75
Junior Ballroom	2,784	87' x 32'	340	250	340	200	—
Raleigh	640	20' x 32'	60	50	60	40	26
Drake	704	22' x 32'	60	50	60	40	26
Elizabethan	640	20' x 32'	60	50	60	40	26
Georgian	800	25' x 32'	60	50	60	40	26
Capitol Room	1,442	84' x 29'	100	60	50	20	—
Hilliard Boardroom	425	25' x 17'	—	—	—	—	20
John Marshall Room	600	30' x 20'	25	25	30	18	—
Manchester Suite	425	25' x 17'	—	—	—	—	20



DOUBLETREE BY HILTON RICHMOND-MIDLOTHIAN

1021 Koger Center Blvd., Richmond, VA 23235

804.379.3800

richmondmidlothian.doubletree.com

This suburban conference center is located in Northern Chesterfield County.

AMENITIES

- ▶ Two ballrooms and 10 breakout rooms
- ▶ Banquets for 520 in the James River Ballroom, 340 in the Shenandoah Ballroom
- ▶ In-room amenities include coffee and tea by The Coffee Bean and Leaf Company, microwave/refrigerator, Sweet Dreams Sleep Experience and complimentary Wi-Fi
- ▶ Midlo-Bistro, a full-service restaurant
- ▶ Indoor pool and exercise room
- ▶ Adjacent to sports and fitness center with indoor/outdoor tennis, jogging trails and a seasonal water park
- ▶ Adjacent to Huguenot Park for picnics and outdoor gatherings
- ▶ Golf packages available
- ▶ Free parking

QUICK STATS

Miles from GRCC

11

Miles from RIC airport

20

Minutes to closest shops, restaurants

<1

Total meeting space (sq. ft.)

26,000

Total rooms/suites

237/9

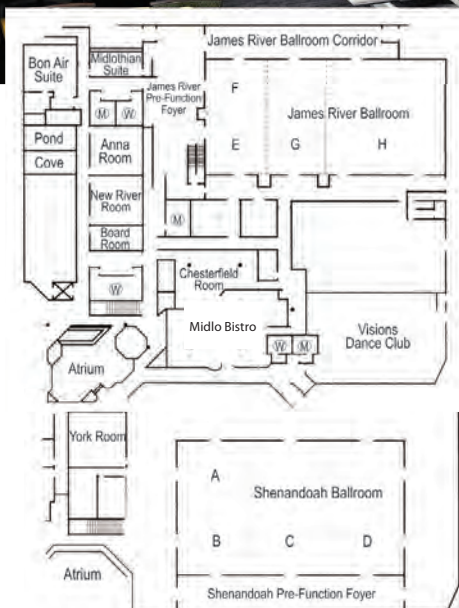

Meeting Space	Sq. Ft.	Reception	Banquet	Theater	Classroom	Conference	U-Shape
Shenandoah Ballroom	6,300	750	340	700	280	—	—
Foyer (pre-function)	1,680	250	—	—	—	—	—
Parlor A & B (each)	1,050	125	50	90	42	40	35
Parlor C & D (each)	2,100	375	150	240	96	80	60
Parlor A & B (combined)	2,100	375	140	200	90	80	60
Parlor C & D (combined)	4,200	600	290	480	192	—	—
York Room	648	50	40	40	24	25	21
James River Ballroom	7,080	900	520	760	360	—	—
Foyer (pre-function)	1,925	150	—	—	—	—	—
Corridor (pre-function)	1,440	100	—	—	—	—	—
Parlor E & F (each)	870	100	50	85	39	25	27
Parlor E & F (combined)	1,740	250	120	180	84	40	45
Parlor G	1,770	250	140	200	90	40	45
Parlor H	3,540	400	260	380	174	40	50
Parlor G & H (combined)	5,310	650	400	580	270	—	—
Midlothian Room	350	20	20	20	12	20	—
New River Room	648	50	40	45	24	25	21
Board Room	324	—	—	—	—	10	—
Atrium	750	50	—	—	—	—	—
Chesterfield Room	1,032	100	50	60	36	35	20
Suites 802 & 806 (each)	—	35	—	—	—	12	—
Pond & Cove (each)	264	—	20	20	12	12	—
Anna Room	648	50	40	45	24	25	21
Bon Air Suite	648	50	40	50	24	25	21

THE EXECUTIVE MEETING CENTER AT EMBASSY SUITES BY HILTON RICHMOND

2925 Emerywood Parkway, Richmond, VA 23294

804.672.8585

embassyrichmond.com

The IACC-approved Executive Meeting Center (EMC) is complemented by spacious two-room suite accommodations. The EMC is designed to provide the optimum environment for high productivity, including the IACC standard equipment, technology and meeting-room amenities that provide maximum comfort to attendees. The comprehensive conference package with all-inclusive pricing allows planners to customize each event and have time to focus on the content of the meeting.



QUICK STATS

Miles from GRCC

5

Miles from RIC airport

17

Minutes to closest shops, restaurants

<1

Total meeting space (sq. ft.)

10,000

Total rooms/suites

224

AMENITIES

- Seven individual meeting rooms
- Dedicated conference planning manager
- Non-glare oversized tables and 18-hour ergonomic chairs
- Surround-room whiteboards and tackable surfaces
- Task lighting with in-room controls
- Sound-proof walls and finishes
- High-speed Internet access and full-service AV support
- Full made-to-order breakfast and two-hour complimentary evening reception daily
- In-room amenities include Internet, two phones, two 37-inch flat-panel TVs, refrigerator, microwave, coffee-maker, iron, ironing board and hair dryer
- Ample free parking

FIRST FLOOR

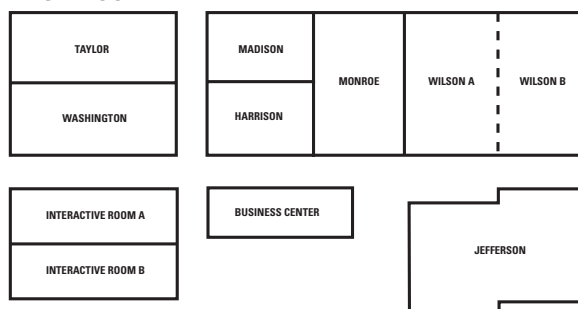

SECOND FLOOR



Meeting Space	Sq. Ft.	Dimensions	Ceiling	Pods of 6	Classroom	Conference	U-Shape	Hollow
Washington	792	33' x 24'	10'	24	28	22	22	24
Taylor	792	33' x 24'	10'	24	28	22	22	24
Madison	660	30' x 22'	10'	18	18	16	16	16
Harrison	660	30' x 22'	10'	18	18	16	16	18
Monroe	1,218	42' x 29'	10'	48	50	28	28	36
Wilson A	1,218	42' x 29'	10'	48	50	28	28	36
Wilson B	1,218	42' x 29'	10'	48	50	28	28	36
Wilson A & B	2,436	42' x 58'	10'	96	110	—	—	—
Interactive Room A	416	32' x 13'	8'	—	—	6	—	—
Interactive Room B	416	32' x 13'	8'	—	—	6	—	—
Exec. Boardroom (3)	304	13' x 18'	8'	—	—	10	—	—
Jefferson	1,540	52' x 32'	8'	—	40	—	—	40
Second Fl. Terrace	1,105	48' x 37'	—	—	—	—	—	—

HOTEL FACILITIES

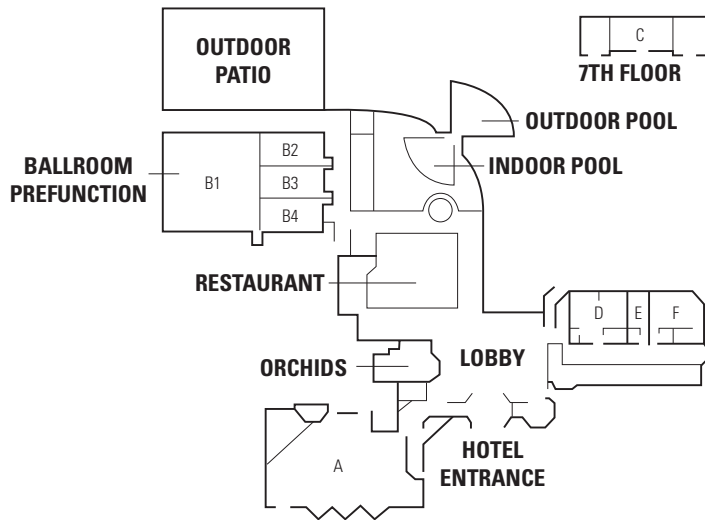

FOUR POINTS BY SHERATON RICHMOND

9901 Midlothian Turnpike, Richmond, VA 23235

804.323.1144

sheratonrichmondparksouth.com

The Sheraton Park South offers all the modern conveniences and amenities to make you feel comfortable and connected.

AMENITIES

- Cafe Palm Restaurant and The Ivy Lounge
- Indoor/outdoor swimming pool and Jacuzzi
- Business center
- Sheraton Sweet Sleeper bed in all rooms
- Adjacent to Moorefield Park lakes and walking trails
- Flexible meeting rooms
- Enterprise car rental service available
- Complimentary high-speed Internet access in all guest rooms
- Five minutes from Chesterfield Town Center

QUICK STATS

Miles from GRCC

15

Miles from RIC airport

20

Minutes to closest shops, restaurants

<1

Total meeting space (sq. ft.)

7,628

Total rooms/suites

183/11

Meeting Space	Sq. Feet	Dimensions	Height	Banquet	Theater	Reception	Classroom	U-Shape	Square	Conference
Chesapeake	2,400	60' x 40'	—	200	275	300	95	—	—	—
Ballroom Prefunction	720	50' x 9'	—	—	—	150	—	—	—	—
Ballroom	4,000	80' x 50'	—	350	450	550	200	—	—	—
Eppington	2,250	50' x 45'	—	200	250	275	110	—	—	—
Ampt Hill	595	35' x 17'	—	30	50	50	30	—	—	20
Castlewood	595	35' x 17'	—	30	50	50	30	—	—	20
Alandale	595	35' x 17'	—	30	50	50	30	—	—	20
Castlewood & Alandale	1,190	35' x 17'	—	75	120	100	30	—	—	35
Alandale, Castlewood, Ampt Hill	1,785	51' x 35'	—	125	170	150	30	—	—	50
Bon Air	400	25' x 17'	—	—	—	—	—	—	—	20
Salisbury	360	24' x 15'	—	—	—	—	—	—	—	15
Moorefield	288	18' x 16'	—	—	—	—	—	—	—	8
Bellgrade	180	15' x 12'	—	—	—	—	—	—	—	10

FOUR POINTS BY SHERATON AIRPORT

4700 S. Laburnum Avenue, Richmond, VA 23231

804.226.4300

fourpointsrichmondairport.com

The Richmond airport hotel has flexible pre-function and event space and can host groups of up to 325 guests. So let the friendly staff help you plan your next Richmond meeting or special event.

QUICK STATS

Miles from GRCC

6

Miles from RIC airport

3

Minutes to closest
shops, restaurants

<1

Total meeting
space (sq. ft.)

11,000

Total rooms/suites

152/3

AMENITIES

- 24-hour shuttle service to and from RIC airport or within a five mile radius of the hotel
- 24-hour fitness center
- Indoor pool open daily
- Terra Nova Grille and Lounge, a full-service restaurant featuring Southern cuisine
- Free coffee in the lobby
- Free high speed internet access

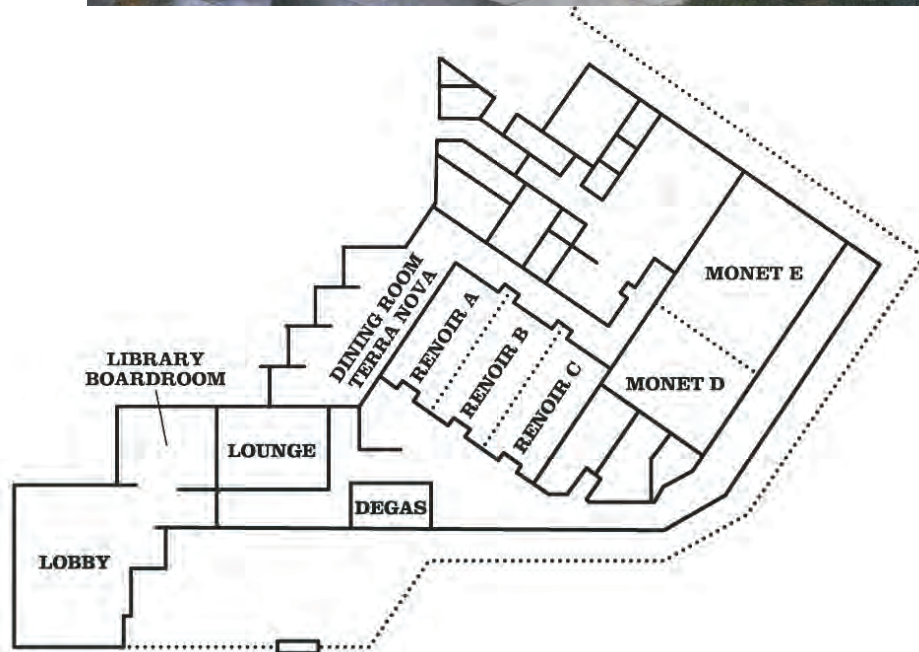

Meeting Space	Sq. Ft.	Dimensions	Ceiling	Reception	Banquet	Theater	Conference	Classroom	U-Shape	Hollow Sq.
Monet E	1,862	49' x 38'	10'	200	64	200	40	75	40	47
Renoir Ballroom	2,400	60' x 40'	12'	250	200	250	—	100	50	57
Monet D	1,102	29' x 38'	10'	120	48	120	30	60	25	32
Monet Ballroom	2,964	78' x 38'	10'	325	240	325	—	140	60	67
Atrium	2,250	50' x 45'	40'	175	150	150	—	—	—	—
Renoir Prefunction	2,100	70' x 30'	10'	50	—	—	—	—	—	—
Renoir A & B or B & C	1,600	40' x 40'	12'	150	128	150	60	60	40	47
Monet Prefunction	1,001	100' x 10'	10'	50	—	—	—	—	—	—
The Degas Boardroom	200	10' x 20'	12'	10	8	15	10	—	—	—
The Library Boardroom	529	23' x 23'	10'	30	30	—	15	—	—	—
Renoir A, B or C	800	20' x 40'	12'	75	64	75	30	30	30	37

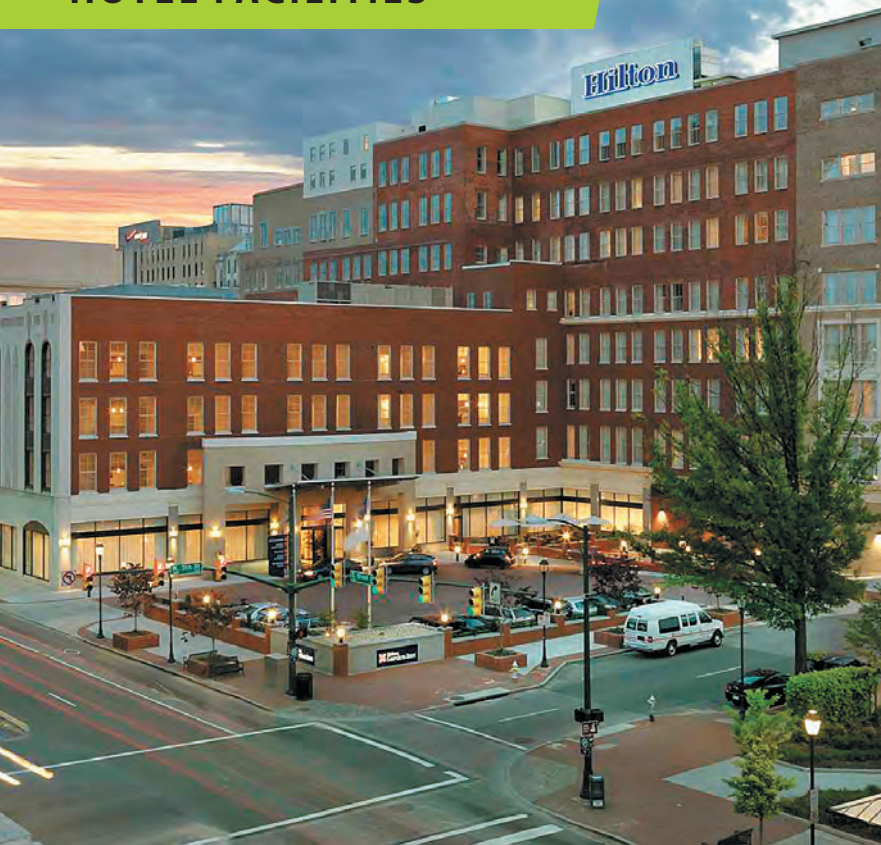

HILTON RICHMOND DOWNTOWN

501 E. Broad St., Richmond, VA 23219
804.344.4300
richmonddowntown.hilton.com

The Hilton Richmond Downtown, built in the historic Miller & Rhoads Department Store building, is located in a vibrant section of the city and within walking distance of many cultural and entertainment venues.

AMENITIES

- Complimentary wired and wireless high-speed Internet in all guest rooms
- Full-service catering with dedicated catering and event specialists
- Refrigerator in each room
- Complimentary 24-hour business center
- Herb N' Kitchen, serving breakfast, lunch and dinner
- Full-service lounge, Thirst & Fifth
- Indoor swimming pool, Jacuzzi and fitness center
- Complimentary shuttle available (from 6 a.m. to 10 p.m. daily) for destinations within a two-mile radius of the hotel
- Executive floor and lounge

QUICK STATS

Miles from GRCC
Across the Street

Miles from RIC airport
9

Minutes to closest shops, restaurants
<1

Total meeting space (sq. ft.)
15,000

Total rooms/suites
250/15

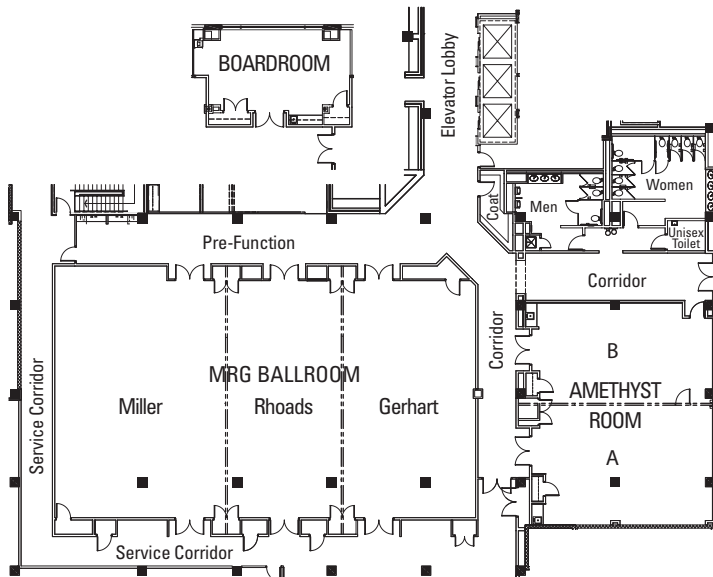

Meeting Space	Sq. Ft.	Dimensions	Ceiling	Banquet	Theater	Reception	Classroom	U-Shape	Conference	Hollow Sq.
Boardroom	406	14' x 29'	10'	—	—	—	—	—	10	—
Amethyst	1,575	45' x 35'	9'	128	180	170	90	30	—	40
Amethyst "A"	700	20' x 35'	9'	72	77	90	50	20	25	23
Amethyst "B"	875	25' x 35'	9'	56	100	70	39	25	20	30
MRG Ballroom	3,080	88' x 35'	12'	256	399	350	220	—	—	—
Miller	994	35' x 28'	12'	80	134	105	60	24	36	30
Rhoads	852	35' x 24'	12'	64	129	90	63	15	36	20
Gerhart	1,278	36' x 35'	12'	105	171	135	82	30	40	36
Pre-function Area	1,362	n/a	n/a	—	—	126	—	—	—	—

Additional 9,000 sq. ft. of space available in fall 2015.

HILTON RICHMOND HOTEL & SPA SHORT PUMP

12042 W. Broad St., Richmond, VA 23233

804.364.3600

hiltonrichmond.com

Located adjacent to the acclaimed Short Pump Town Center, the Hilton Richmond Hotel & Spa offers beautiful function space, fine dining and plentiful attractions, activities and upscale shopping next door.

QUICK STATS

Miles from GRCC

15

Miles from RIC airport

25

Minutes to closest shops, restaurants

Adjacent to a mall

Total meeting space (sq. ft.)

24,653

Total rooms/suites

254/4

AMENITIES

- Flat-panel televisions, iPod alarm clocks and the Hilton Signature Bed
- Abundant pre-function space and 20-foot ceilings in the Capital Ballroom
- Shula's America's Steak House and Lounge
- Aroma Café proudly serves Starbucks coffee
- Complimentary high-speed wireless Internet service
- Indoor swimming pool, whirlpool, fitness center and sundeck
- Aura Spa and Salon is open seven days a week
- Executive floor and executive lounge with junior and executive suites
- Complimentary surface and underground parking
- Customized group webpages for ease of online reservations

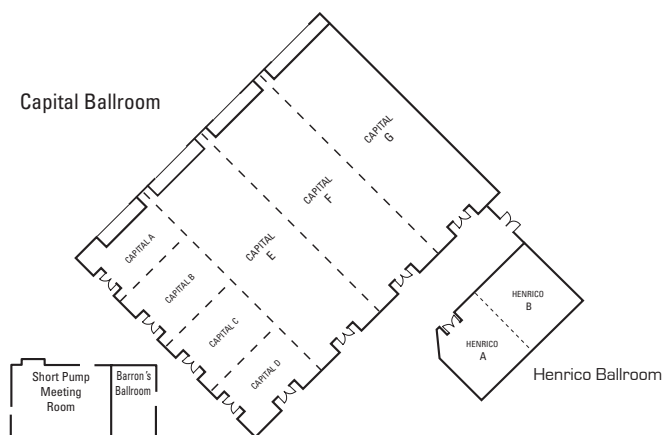

Meeting Space	Sq. Ft.	Dimensions	Rounds of 10	Classroom	Theater	Conference
Capital Ballroom	10,332	84' x 124'	795	680	1,000	—
Capital A	651	21' x 31'	50	40	65	—
Capital B	651	21' x 31'	50	40	65	—
Capital C	651	21' x 31'	50	40	65	—
Capital D	651	21' x 31'	50	40	65	—
Capital E	2,604	31' x 84'	200	170	270	—
Capital F	2,604	31' x 84'	200	170	270	—
Capital G	2,520	31' x 84'	190	160	265	—
Capital Pre-function	6,200	—	—	—	—	—
Henrico Ballroom	1,274	26' x 49'	90	85	130	—
Henrico A	520	26' x 20'	40	35	55	—
Henrico B	754	26' x 29'	50	50	75	—
Towne Center (pre-function)	925	—	—	—	—	—
Barron's Ballroom	400	25' x 16'	—	—	—	16
Short Pump Meeting Room	910	35' x 26'	70	60	90	—



HOMewood SUITES

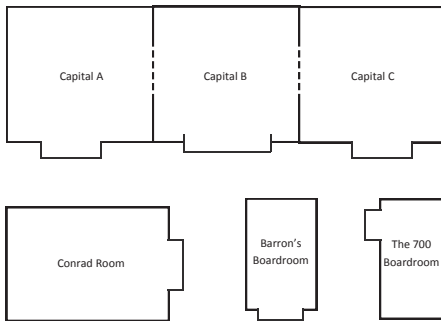

HAMPTON INN & SUITES

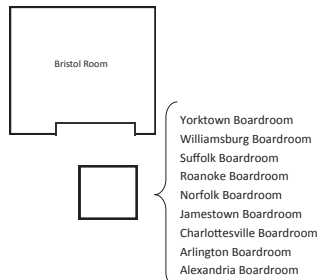

HOMewood SUITES AND HAMPTON INN & SUITES RICHMOND DOWNTOWN

700 E. Main St., Richmond, VA 23219

Homewood Suites: 804.643.2900,

richmonddowntown.homewoodsuites.com

Hampton Inn & Suites: 804.643.2500

richmonddowntownsuites.hamptoninn.com

Our convenient location in the heart of the Richmond financial district is just steps from the Virginia State Capitol, Federal Courthouse, Richmond Convention Center, and a multitude of entertainment and shopping.

AMENITIES

- Complimentary Wi-Fi in all guest rooms
- Complimentary hot breakfast
- Complimentary 24-hour rooftop fitness center
- Belle and James French-American Restaurant
- Kabana rooftop restaurant, lounge, and event space
- Sip Café featuring cold pressed smoothies and quinoa bowls
- Outdoor rooftop pool

QUICK STATS

Miles from GRCC

<1

Miles from RIC airport

8

Minutes to closest shops, restaurants

<1

Total meeting space (sq. ft.)

6,800

Total rooms/suites

96/148

Meeting Space	Sq. Ft.	Banquet	Conference	Classroom	Hollow Square	Theater	Reception
Capital Ballroom	2840	225		180		300	275
Capital A	945	75	20	60	20	100	90
Capital B	945	75	20	60	20	100	90
Capital C	945	75	20	60	20	100	90
Conrad Room	919	75	20	60	20	100	90
Barron's Boardroom	400	—	10	—	—	—	—
The 700 Boardroom	359	—	8	—	—	—	—
Bristol Room	1054	80	25	65	25	110	100
Yorktown Boardroom	130	8	8	—	—	—	—
Williamsburg Boardroom	130	8	8	—	—	—	—
Suffolk Boardroom	130	8	8	—	—	—	—
Roanoke Boardroom	130	8	8	—	—	—	—
Norfolk Boardroom	130	8	8	—	—	—	—
Jamestown Boardroom	130	8	8	—	—	—	—
Charlottesville Boardroom	130	8	8	—	—	—	—
Arlington Boardroom	130	8	8	—	—	—	—
Alexandria Boardroom	130	8	8	—	—	—	—

THE JEFFERSON HOTEL

101 W. Franklin St., Richmond, VA 23220

804.788.8000 or 800.424.8014

jeffersonhotel.com

The Jefferson Hotel is a national historic landmark and a member of Preferred Hotels and Resorts.

QUICK STATS

Miles from GRCC

<1

Miles from RIC airport

10

Minutes to closest shops, restaurants

<1

Total meeting space (sq. ft.)

26,000

Total rooms/suites

150/15

AMENITIES

- Business Center
- Concierge on duty 24 hours a day
- TJ's Restaurant and Lounge for a casual meal next to Rotunda
- Nationally recognized Lemaire restaurant
- State-of-the-art health club with indoor pool
- Complimentary wireless high-speed Internet access
- Complimentary downtown transportation



ROTUNDA LEVEL

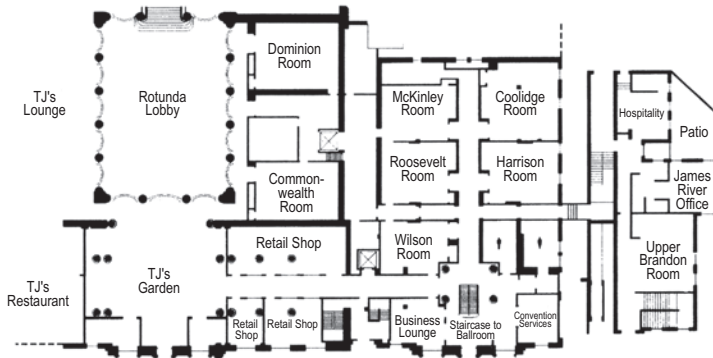

PALM COURT LEVEL

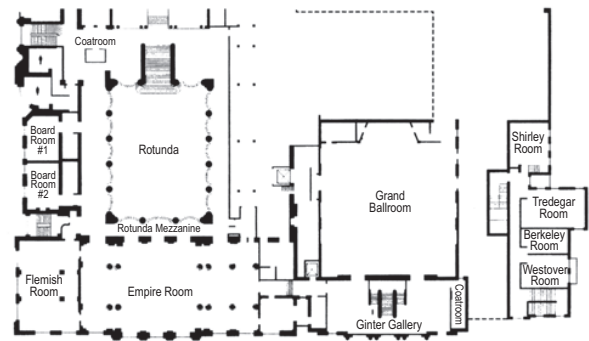

Meeting Space	Sq. Ft.	Reception	Banquet	Theater	Classroom	Boardroom
McKinley Room	456	30	40	30	20	—
Harrison Room	528	50	40	40	35	—
Wilson Room	456	30	30	30	20	—
Coolidge Room	696	50	50	35	35	—
Roosevelt Room	552	50	50	35	30	—
Dominion Room	806	100	60	60	45	—
Commonwealth Room	677	100	50	50	30	—
Grand Ballroom	4,556	600	400	450	300	—
Empire Room	4,050	500	300	250	150	—
Flemish Room	1,320	125	8	100	50	—
Washington Room	336	—	—	—	—	10
Monticello Room	384	—	—	—	—	10
Rotunda Mezzanine	4,254	450	—	—	—	—
Rotunda Lobby	2,944	450	—	—	—	—

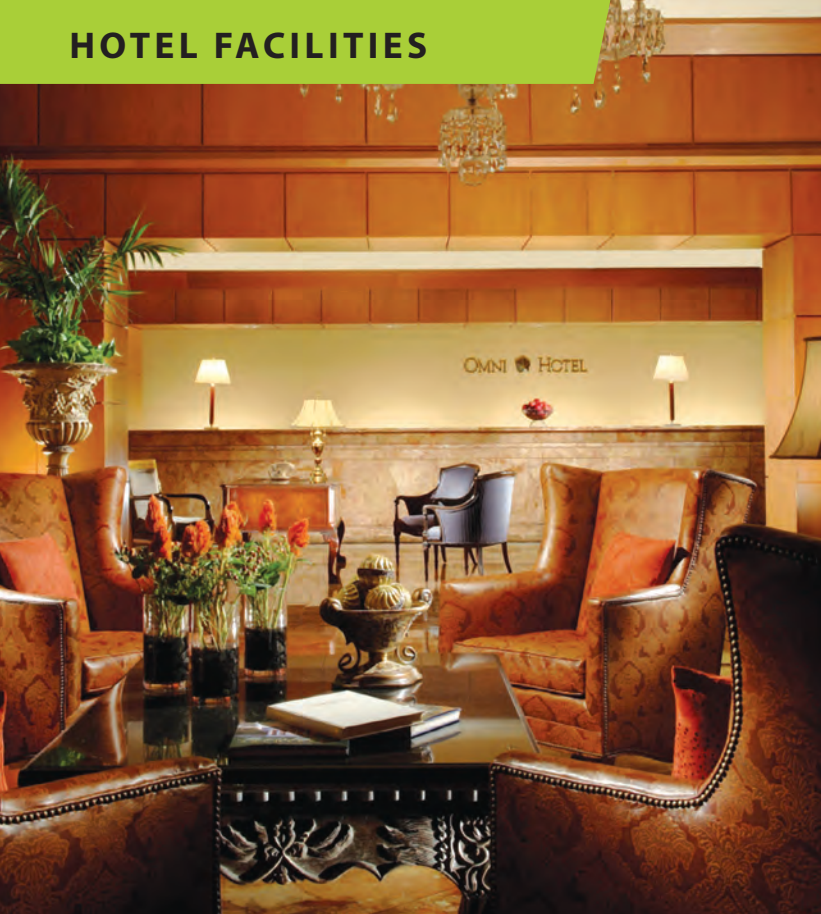

OMNI RICHMOND HOTEL

100 S. 12th St., Richmond, VA 23219

804.344.7000

omnirichmond.com

The Omni Richmond Hotel is located at Richmond's premier business and leisure address renovated in 2015. Overlooking the scenic James River in the heart of the city's financial and historic districts, the hotel offers both superb business amenities and rich American history. Fine dining, shopping and entertainment options are available right outside the front door in historic Shockoe Slip.

AMENITIES

- Each guest room reflects a timeless, elegant décor with inspiring views of the city or the winding James River.
- Trevi's Grille is an Italian trattoria restaurant in an open atrium setting. The menu reflects an offering of classic Italian dishes from the many regions of Italy. The Omni also offers the "Art of Breakfast." Open for breakfast, lunch and dinner.
- Trevi's Market, a carry-out pizzeria, offers pizza, Italian sandwiches, salads and pastries.
- Guest-room dining available from 6 a.m. to 11 p.m.
- A full-service Starbucks coffee shop is offered in the hotel's main lobby.

QUICK STATS

Miles from GRCC

1

Miles from RIC airport

9

Minutes to closest shops, restaurants

<1

Total meeting space (sq. ft.)

15,000

Total rooms/suites

361/14

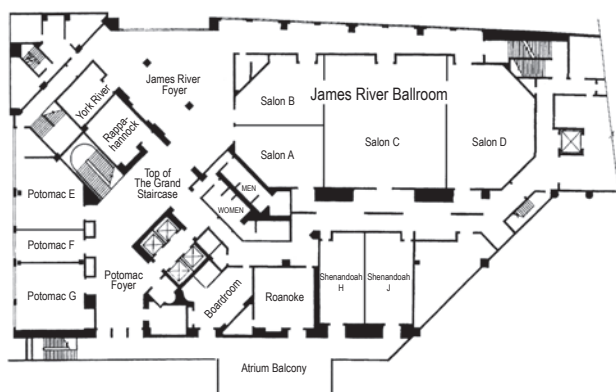

Meeting Space	Sq. Ft.	Reception	Banquet	Theater	Classroom
James River Ballroom (total)	7,027	720	550	800	435
Salon A	1,174	140	65	140	50
Salon B	1,000	130	60	120	45
Salon C	2,679	250	220	260	180
Salon D	2,174	200	170	210	100
York River	340	30	24	30	22
Rappahannock	462	50	40	45	32
Potomac (total)	2,396	310	150	238	145
Salon E	986	125	60	94	56
Salon F	526	60	32	50	34
Salon G	884	125	60	94	56
Boardroom	256	—	16	—	—
Roanoke	676	60	50	45	32
Shenandoah (total)	1,426	150	120	130	112
Salon H	620	60	50	63	56
Salon J	806	60	50	63	56
Magnolia Room and Wine Bar	2,460	225	170	250	100

SPECO HOTELS OF RICHMOND AND CONVENTION CENTER

6531 W. Broad St., Richmond, VA 23230
804.977.6440

Southern hospitality and stylish accommodations await you at the Speco Hotels of Richmond and Convention Center. Set off of I-64, the hotel is conveniently located directly between downtown Richmond and the bustling West End.

QUICK STATS

Miles from GRCC

5

Miles from RIC airport

15

Minutes to closest
shops, restaurants

<1

Total meeting
space (sq. ft.)

10,000

Total rooms/suites

280/10

AMENITIES

- Complimentary parking
- Indoor pool and whirlpool
- Complimentary high speed wired & wireless Internet
- The Sapphire Grill and Lounge is open for breakfast and dinner
- 24-hour fitness facility
- Business Center
- Personalized service from a catering director
- Direct access to I-64 and near the I-95 interchange
- Set next to Altria, Genworth and Reynolds corporate offices

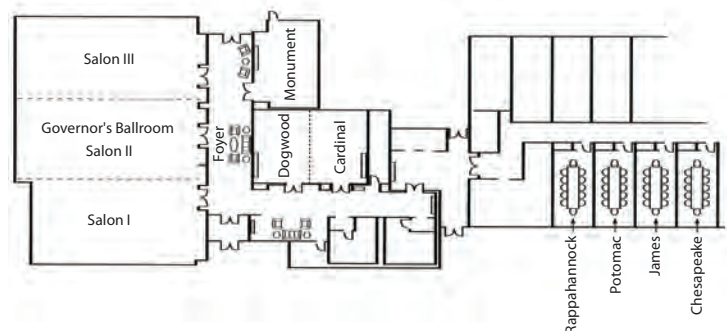
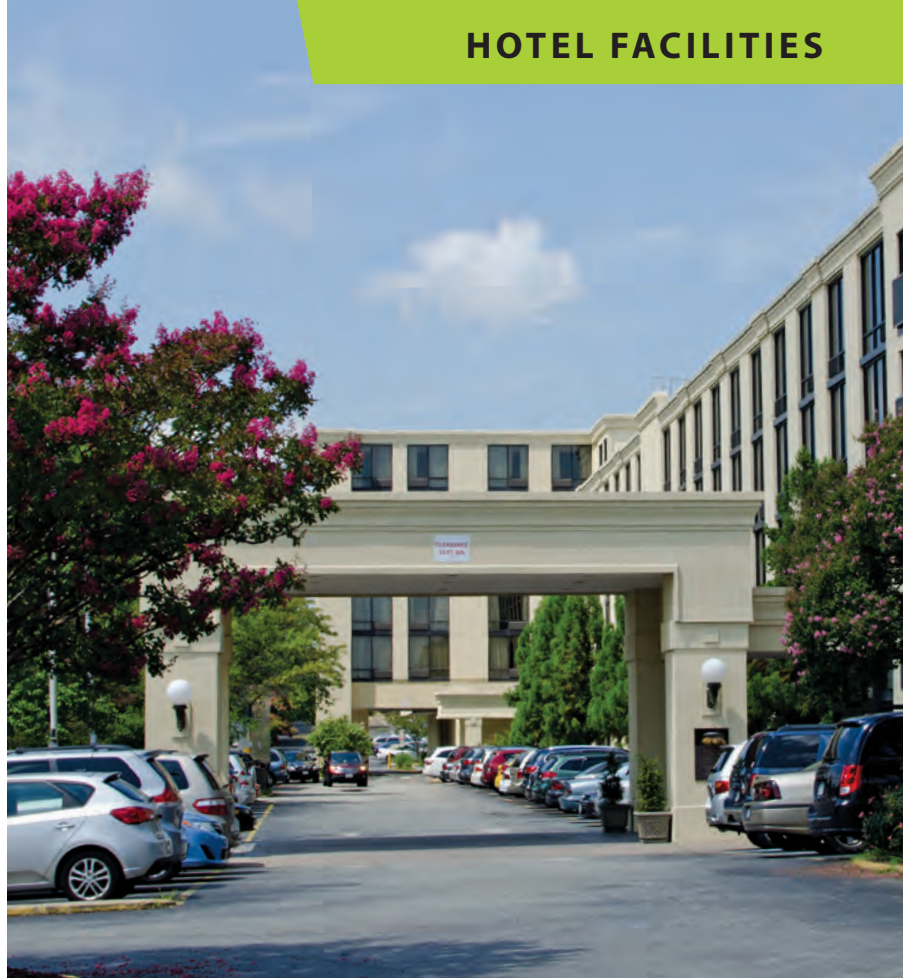

Meeting Space	Sq. Feet	Dimensions	Height	Theater	Reception	Classroom	U-Shape	Conference	Banquet
Governor's Ballroom	5,330	82' x 65'	12'	500	700	275	—	—	380
Salon I	1,680	28' x 60'	12'	120	180	75	50	40	100
Salon II	1,690	26' x 65'	12'	120	180	75	50	40	100
Salon III	1,680	28' x 60'	12'	120	180	75	50	40	100
Pre-function	1,530	14' x 120'	10'	—	75	—	—	—	—
Dogwood/Cardinal	920	38' x 24'	10'	80	50	36	32	36	60
Cardinal	460	19' x 24'	10'	40	25	18	16	18	30
Dogwood	460	19' x 24'	10'	40	25	18	16	18	30
Monument	725	22' x 33'	10'	50	40	27	20	20	40
Chesapeake Boardroom	365	13' x 28'	8'	—	—	—	—	12	—
James Boardroom	365	13' x 28'	8'	—	—	—	—	12	—
Potomac Boardroom	365	13' x 28'	8'	—	—	—	—	12	—
Rappahannock Boardroom	365	13' x 28'	8'	—	—	—	—	12	—

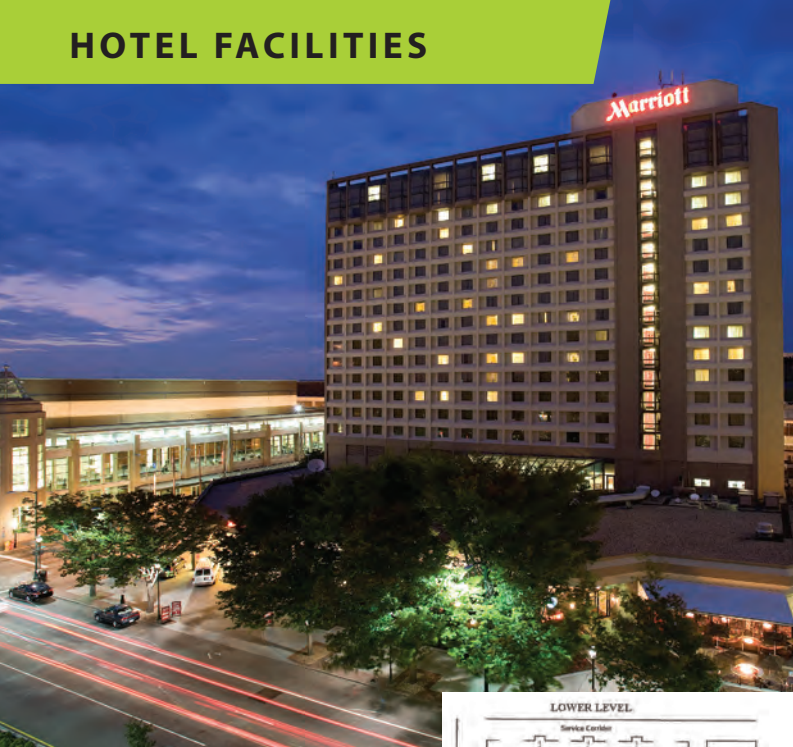

RICHMOND MARRIOTT

500 E. Broad St., Richmond, VA 23219

804.643.3400

marriott.com/ricdt

Located in the heart of downtown Richmond, the recently renovated Marriott is adjacent to the Greater Richmond Convention Center and located steps away from the Richmond Coliseum. It is Richmond's largest convention hotel.

AMENITIES

- Walking distance to a wide array of historic and cultural attractions
- Expansive health club with indoor pool
- Professional convention-services department
- Starbucks coffee shop and boarding-pass terminal
- Complete teleconference capabilities
- Full-service executive business center
- Conceive
- In-house audiovisual department

QUICK STATS

Miles from GRCC

Adjacent

Miles from RIC airport

8

Minutes to closest shops, restaurants

<1

Total meeting space (sq. ft.)

27,000

Total rooms/suites

410/4

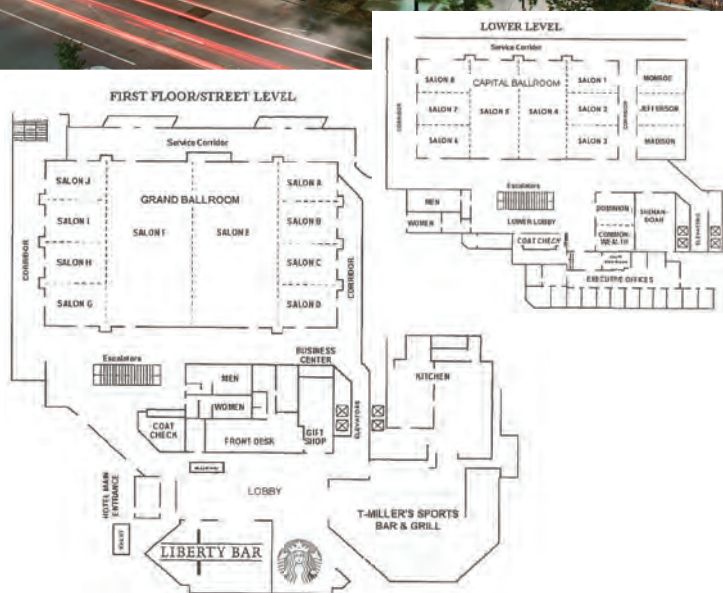

Meeting Space	Sq. Ft.	Reception	Banquet	Theater	Classroom	Conference	U-Shape
Grand Ballroom	15,092	2,000	1,120	1,700	840	—	—
Salons A-D, G-J	762	65	40	70	32	20	14
Salons AB, BC, CD, GH, HI or IJ	1,535	140	80	140	70	28	30
ABC, BCD, GHI, HIJ	2,308	220	110	210	100	—	36
ABCD or GHIJ	3,071	300	140	320	130	—	50
Salons E & F (each)	4,475	600	280	390	200	—	—
ABCDE or EFGHIJ	7,546	900	470	760	400	—	—
Capital Ballroom	7,919	1,000	580	700	360	—	—
Salons 1-3 & 6-8 (each)	683	62	40	55	26	16	14
Salons 4 & 5 (each)	1,906	200	100	190	80	36	40
Salons 1-2, 2-3, 6-7 or 7-8 (combined)	1,365	120	70	110	55	30	24
Salons 1-2-3 or 6-7-8 (combined)	2,047	220	100	180	85	—	44
Salons 1-2-3-4 or 5-6-7-8 (combined)	3,954	450	230	300	160	—	—
Salons 1-2-3-4-5 or 4-5-6-7-8	5,860	700	340	600	250	—	—
Madison, Jefferson & Monroe (each)	618	60	30	50	24	14	16
Dominion	495	45	30	45	20	14	14
Commonwealth	440	45	30	45	20	14	14
Dominion & Commonwealth	939	60	50	90	34	24	20
Capital	988	60	50	70	40	24	22
Apple Boardroom	624	—	—	—	—	12	—

RICHMOND MARRIOTT SHORT PUMP

4240 Dominion Blvd., Glen Allen, VA 23060

804.965.9500

marriott.com/ricmw

Richmond Marriott Short Pump hotel is conveniently located in the heart of Innsbrook, close to office parks, world-class shopping and restaurants. Use the jogging trail that winds through Innsbrook's beautiful office park and lakes, relax in the Great Room and Bourbon Bar, indulge in New American cuisine or enjoy a cocktail in a warm, relaxed setting.

QUICK STATS

Miles from GRCC

13

Miles from RIC airport

18

Minutes to closest
shops, restaurants

<1

Total meeting
space (sq. ft.)

8,900

Total rooms/suites

243/9

AMENITIES

- High-speed wired and wireless Internet
- Complimentary on site parking
- Coffee in lobby
- Coffee/tea in room
- Local restaurant dinner delivery
- Toll-free phone calls
- Room service, 6:30 a.m. to 11:00 p.m.
- In room safes
- In room refrigerators
- Onsite fitness center
- Indoor swimming pool
- Close to I-95, I-295, VA-288
- 5 miles to Amtrak Train Station
- Car rentals nearby

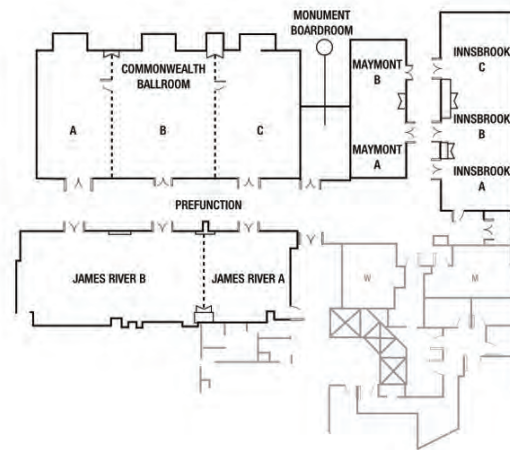

Meeting Space	Sq. Feet	Dimensions	Height	Theater	Reception	Classroom	U-Shape	Conference	Rounds
Commonwealth Ballroom	3,116	38' x 82'	18'	375	330	240	—	—	220
Salon A	874	38' x 23'	18'	100	90	63	30	36	60
Salon B	1,216	38' x 32'	18'	150	145	84	33	42	90
Salon C	1,026	38' x 27'	18'	120	105	84	33	42	70
Ballroom Foyer	1,066	13' x 82'	12'	—	145	—	—	—	—
Monument Boardroom	322	14' x 23'	12'	—	—	—	—	12	12
Maymont	792	18' x 44'	11'	80	75	42	36	42	50
Maymont A	450	18' x 25'	11'	44	45	24	21	24	30
Maymont B	342	18' x 19'	11'	32	30	18	15	18	20
Innsbrook	1,116	18' x 62'	12'	132	145	63	54	60	90
Innsbrook A	360	18' x 20'	12'	36	45	18	15	18	30
Innsbrook B	270	18' x 15'	12'	30	30	18	9	12	20
Innsbrook C	468	18' x 26'	12'	52	60	24	21	24	40



WESTIN RICHMOND

6631 W. Broad St., Richmond, VA 23230

804.282.8444

westinrichmond.com

The new Westin Richmond is ideally situated in the vibrant Near West End of Richmond, with short distances to the West End and downtown.

AMENITIES

- ▶ Heavenly® Bed and the Heavenly® Bath/Shower in all rooms
- ▶ High-speed wireless and wired Internet access
- ▶ Flat-panel televisions, telephone with speaker phone, voicemail
- ▶ Crossings, a casually sophisticated restaurant; a warm, inviting lobby bar and lounge; and 24-hour in-room dining
- ▶ Space includes elegant ballrooms, meeting rooms, an executive boardroom and a conference hospitality suite
- ▶ A 24-hour fitness facility with cardiovascular equipment, weight machines, a heated indoor pool and hot tub

QUICK STATS

Miles from GRCC

7

Miles from RIC airport

15

Minutes to closest shops, restaurants

<1

Total meeting space (sq. ft.)

17,000

Total rooms/suites

250/11

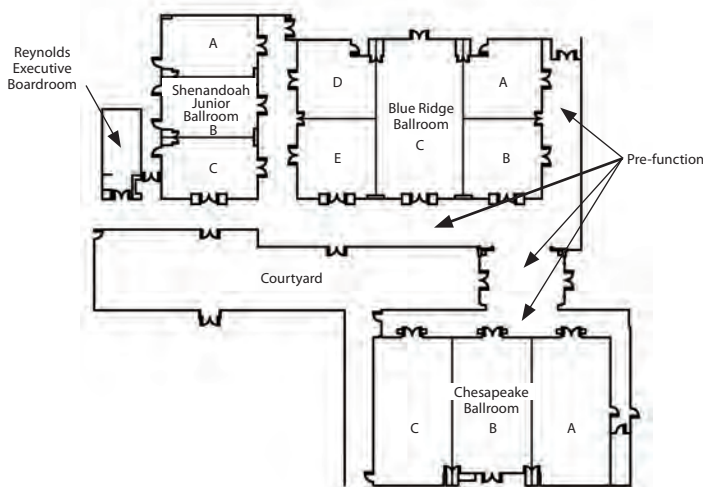

Meeting Space	Sq. Ft.	Dimensions	Ceiling	Banquet	Theater	Conference	Reception	Classroom	U-Shape
Blue Ridge Ballroom — Total	4,387	56' x 84'	15' 10"	300	550	78	500	280	70
Salon A	683	27' x 27'	15' 10"	50	80	15	65	35	20
Salon B	712	27' x 27'	15' 10"	50	80	15	65	35	20
Salon AB	1,395	54' x 27'	15' 10"	100	165	40	120	80	45
Salon C	1,595	56' x 30'	15' 10"	120	200	40	180	110	50
Salon ABC	2,990	54' x 57'	15' 10"	250	320	50	300	200	60
Salon D	684	27' x 27'	15' 10"	50	80	15	65	35	20
Salon E	713	27' x 27'	15' 10"	50	80	15	65	35	20
Salon DE	1,397	54' x 27'	15' 10"	100	150	40	120	80	45
Salon CDE	2,992	54' x 57'	15' 10"	250	420	50	300	200	60
Shenandoah Jr. Ballroom — Total	1,989	62' x 33'	17'	150	230	55	160	130	60
Salon A	664	21' x 32'	17'	50	70	20	50	30	18
Salon B	668	20' x 33'	17'	50	70	20	50	30	18
Salon C	656	21' x 32'	17'	50	70	20	50	30	18
Salon AB	1,332	41' x 33'	17'	100	120	30	100	60	35
Salon BC	1,324	41' x 33'	17'	100	120	30	100	60	35
Reynolds Executive Boardroom	390	30' x 13'	10'	—	—	12	—	—	—
Pre-function	3,420	104' x 16' x 49' & 10' x 44' x 10'	17'	—	—	—	250	—	—
Chesapeake Ballroom — Total	4,769	56' x 90'	13' 8"	350	625	100	550	325	100
Salon A	1,625	56' x 30'	13' 8"	130	200	50	200	125	45
Salon B	1,519	51' x 30'	13' 8"	100	150	35	150	90	35
Salon C	1,625	56' x 30'	13' 8"	130	200	50	200	125	45
Salon AB	3,143	56' x 60'	13' 8"	270	350	85	350	215	70
Salon BC	3,143	56' x 60'	13' 8"	270	350	85	350	215	70
Chesapeake Pre-function	1,956	93' x 9' & 40' x 27'	13' 8"	—	—	—	200	—	—
Courtyard	5,850	130' x 45'	—	—	—	—	300	—	—
Conference Suite (2nd floor)	468	26' x 18'	8' 8"	—	—	8	25	—	—

WYNDHAM VIRGINIA CROSSINGS HOTEL AND CONFERENCE CENTER

1000 Virginia Center Parkway, Glen Allen, VA 23059

804.727.1400

wyndhamvirginiacrossings.com

The AAA Four-Diamond Wyndham Virginia Crossings Hotel & Conference Center offers 183 deluxe rooms, two restaurants, fitness center, outdoor pool and privileges at the adjacent Crossings Golf Course. Set on a 20-acre estate overlooking the award-winning Crossings Golf Course, it is a favorite destination for gatherings of all types and provides a wealth of amenities.

QUICK STATS

Miles from GRCC

11

Miles from RIC airport

20

Minutes to closest
shops, restaurants

1

Total meeting
space (sq. ft.)

28,000

Total rooms/suites

183/5

AMENITIES

- ▶ Deluxe guest rooms, including suites equipped with 32-inch flat panel television with complimentary high-speed Internet access
- ▶ 24/7 fitness center with Life Fitness machines, Elliptical Gliders, treadmills and Stairmaster
- ▶ Outdoor pool, hot tub, volleyball and basketball courts, and horseshoe pit
- ▶ Access to The Crossings Golf Club, an 18-hole Joe Lee designed golf course
- ▶ 15 minutes from downtown Richmond and 15 minutes to Kings Dominion

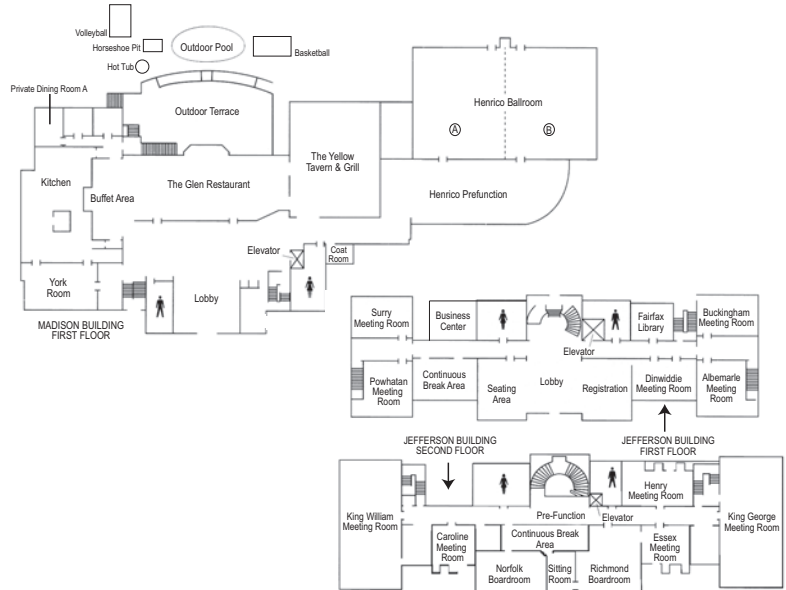

Meeting Space	Sq. Ft.	Banquet	Theater	Classroom	Conference	U-Shape	Hollow
Powhatan & Albemarle (each)	616	48	60	20	24	16	18
Surry	588	36	50	18	14	14	18
Dinwiddie	588	30	40	24	16	16	20
Fairfax Library	324	—	—	—	8	—	—
Buckingham	540	40	60	24	20	16	18
King William & King George (each)	1,674	100	150	64	34	36	42
Henry	480	20	40	12	12	20	12
Essex & Caroline (each)	342	16	30	10	12	9	11
Richmond Boardroom	672	—	—	—	18	—	—
Norfolk Boardroom	414	—	—	—	10	—	—
Henrico Ballroom	4,700	336	400	180	46	50	62
Henrico Ballroom A & B (each)	2,350	168	200	80	30	30	40
Henrico Pre-function	2,400	—	—	—	—	—	—
York	528	44	60	30	18	24	22
Outdoor Terrace	1,750	70	80	—	—	—	—
Hanover	2,128	120	140	75	40	36	48
Brunswick	1,080	60	100	50	22	24	34
Spotsylvania	1,012	60	84	50	22	24	34
Chesterfield	1,176	60	80	36	22	24	30
Private Dining Room	216	—	—	—	10	—	—

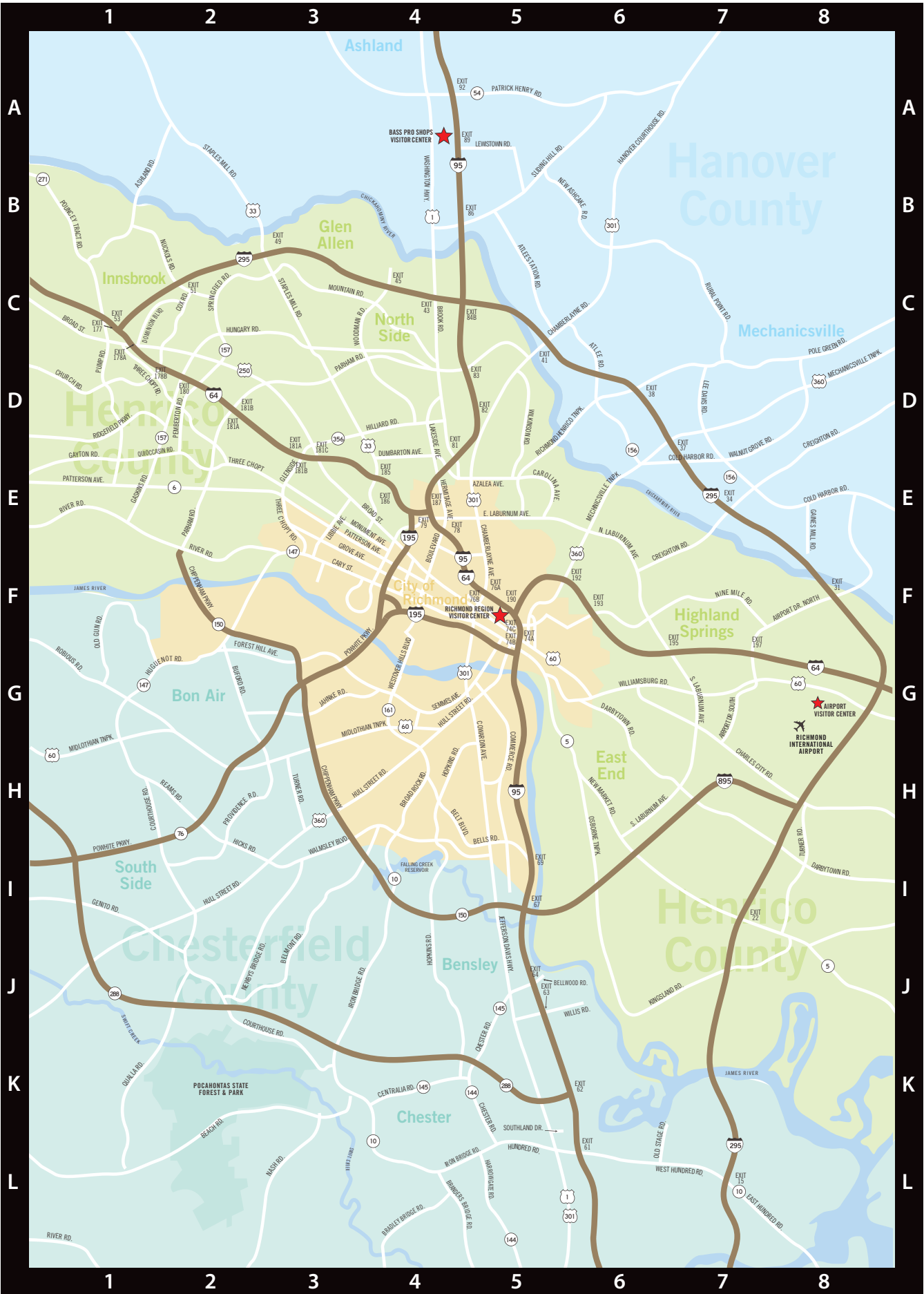

NAME, (MAP COORDINATES)	ADDRESS	PHONE (AREA CODE 804)	ROOMS/SUITES
DOWNTOWN			
The Berkeley Hotel, (F-5)	1200 E. Cary St.	780.1300	55/1
Commonwealth Park Suites Hotel, (F-5)	901 Bank St.	343.7300	59/59
Courtyard Richmond Downtown, (F-5)	1320 E. Cary St.	754.0007	135/0
Crowne Plaza Richmond Downtown, (F-5)	555 E. Canal St.	788.0900	298/29
Graduate Richmond (F-5) <i>(opens spring 2016)</i>	301 W. Franklin St.	644.9871	TBD
Hampton Inn & Suites/Homewood Suites Richmond Downtown, (F-5) <i>(opens December 2015)</i>	700 E. Main St.	777.9000 Ext. 123	0/250
Hilton Richmond Downtown, (F-5)	501 E. Broad St.	344.4300	250/15
Holiday Inn Express Downtown Richmond, (F-5)	201 E. Cary St.	788.1600	80/20
The Jefferson Hotel, (F-5)	101 W. Franklin St.	788.8000	150/15
Linden Row Inn, (F-5)	100 E. Franklin St.	783.7000	70/7
Massad House Hotel, (F-5)	11 N. Fourth St.	648.2893	64/11
Omni Richmond Hotel, (F-5)	100 S. 12th St.	344.7000	361/14
Quirk Hotel, (F-5)	201 W. Broad St.	844.757.8475	70/5
Residence Inn by Marriott, (F-5)	14 S. 14th St.	225.5550	0/75
Richmond Marriott Hotel, (F-5)	500 E. Broad St.	643.3400	410/4
EASTERN HENRICO/AIRPORT/MECHANICSVILLE			
Airport Inn Motel, (G-7)	5121 S. Laburnum Ave.	222.4200	16/1
All Day Inn, (G-7)	5500 Williamsburg Road	222.2041	90/0
America's Best Value Inn Richmond Airport, (G-7)	5700 Williamsburg Road	222.2780	115/0
Best Western Richmond Airport, (G-7)	5300 Airport Square Lane	222.8200	124/0
Candlewood Suites Richmond Airport, (G-7)	5400 Audubon Drive	652.1888	103/0
Capital Inn, (G-7)	5408 Williamsburg Road	222.1020	53/0
Comfort Inn Richmond Airport, (G-7)	5240 Airport Square Lane	226.1800	61/0
Courtyard by Marriott Richmond Airport, (G-7)	5400 Williamsburg Road	652.0500	142/15
Doubletree by Hilton Richmond-Airport, (G-8)	5501 Eubank Road	226.6400	160/20
Four Points by Sheraton Richmond Airport, (F-7)	4700 S. Laburnum Ave.	226.4300	151/4
Hampton Inn Mechanicsville, (D-7)	7433 Bell Creek Road	559.0559	80/5
Hampton Inn Richmond Airport, (F-8)	421 International Center Drive	226.1888	104/0
Hilton Garden Inn Richmond Airport, (F-8)	441 International Center Drive	222.3338	130/16
Holiday Inn Express Mechanicsville, (D-7)	7441 Bell Creek Road	559.0022	101/4
Holiday Inn Express Richmond Airport, (F-8)	491 International Center Drive	222.1499	101/6
Holiday Inn Richmond Airport, (F-8)	445 International Center Drive	236.1111	143/0
Homewood Suites by Hilton Airport, (F-8)	5996 Audubon Drive	737.1600	0/125
Hyatt Place Richmond Airport, (F-7)	4401 S. Laburnum Ave.	549.4865	0/151
Microtel Inn & Suites Airport, (F-8)	6000 Audubon Drive	737.3322	100/20
Motel 6 Richmond Airport, (G-7)	5704 Williamsburg Road	222.7600	120/0
Quality Inn & Suites Richmond Airport, (G-7)	5203 Williamsburg Road	222.6450	100/10
Super 8 Richmond Airport, (G-7)	5110 Williamsburg Road	222.8008	50/1

NAME (MAP COORDINATES)	ADDRESS	PHONE (AREA CODE 804)	ROOMS/SUITES
NORTH SIDE/ASHLAND			
America's Best Value Inn, (C-5)	8901 Brook Road	553.8395	38/7
Apple Garden Inn, (A-4)	99 S. Carter Road	798.9291	46/0
Ashland Inn and Suites, (A-4)	810 England St.	798.4231	136/20
Best Western Glen Allen, (D-4)	8507 Brook Road	266.3500	62/18
Best Western Kings Quarters, (just North of A-4)	16102 Theme Park Way	876.3321	248/1
Candlewood Suites Glen Allen, (B-5)	10609 Telegraph Road	262.2240	84/0
Clarion Hotel Richmond Central, (E-4)	3207 N. Boulevard	359.9441	176/3
Comfort Inn & Conference Center, (E-4)	3200 W. Broad St.	359.4061	189/6
Comfort Suites, (B-4)	10601 Telegraph Road	262.2000	0/100
Country Inn & Suites, (just North of A-4)	16250 International St.	612.8450	62/25
Country Inn & Suites by Carlson, (A-4)	11600 Lakeridge Parkway	798.7378	63/18
Courtyard by Marriott, (B-4)	10077 Brook Road	266.6900	146/4
Days Inn, (C-4)	8613 Brook Road	261.0188	36/3
Days Inn Ashland, (A-4)	806 England St.	798.4262	90/0
Days Inn Doswell, (just North of A-4)	16220 International St.	612.8680	48/0
Econo Lodge Kings Dominion South, (A-4)	103 N. Carter Road	798.9221	83/0
Econo Lodge North, (C-4)	8350 Brook Road	262.7070	31/0
Hampton Inn & Suites Virginia Center, (B-4)	1101 Technology Park Drive	261.2266	99/30
Hampton Inn Ashland, (A-4)	705 England St.	752.8444	74/5
Holiday Inn Express Hotel & Suites Ashland, (A-4)	107 S. Carter Road	752.7889	115/66
Howard Johnson Inn & Suites Ashland, (A-4)	107 N. Carter Road	521.2377	64/20
Knights Inn, (C-4)	9002 Brook Road	266.2444	60/0
La Quinta Inn & Suites, (just North of A-4)	16280 International St.	876.6900	0/72
Motel 6 Ashland, (A-4)	101 N. Cottage Green Drive	752.7777	121/0
Quality Inn, (A-4)	801 E. Parham Road	266.8753	80/0
Sleep Inn & Suites Ashland, (A-4)	80 Cottage Green Drive	752.2355	70/38
Sleep Inn North, (C-4)	950 E. Parham Road	515.7800	72/0
Springhill Suites by Marriott at Virginia Center Commons, (B-4)	9701 Brook Road	266.9403	0/136
Super 8 Motel Ashland, (A-4)	806-B England St.	752.7000	100/0
Super 8 Motel Chamberlayne, (D-5)	5615 Chamberlayne Road	262.8880	55/2
Wyndham Virginia Crossings Hotel & Conference Center, (B-5)	1000 Virginia Center Parkway	262.1010	183/5
SOUTH SIDE/CHESTER			
America's Best Value Inn, (H-3)	100 Greshamwood Place	745.0600	78/0
America's Best Value Inn, (J-5)	2126 Willis Road	271.1281	100/0
Best Western Governor's Inn, (G-2)	9826 Midlothian Turnpike	323.0007	80/3
Candlewood Suites, (just South of L-6)	15820 Woods Edge Road	526.0111	0/82
Candlewood Suites Richmond South, (H-5)	4301 Commerce Road	271.0016	0/104
Comfort Inn Chester, (L-5)	2100 W. Hundred Road	751.0000	122/10

NAME (MAP COORDINATES)	ADDRESS	PHONE (AREA CODE 804)	ROOMS/SUITES
Country Inn & Suites by Carlson, (J-5)	2401 Willis Road	275.5900	50/15
Courtyard by Marriott Richmond/Chester, (L-6)	2001 W. Hundred Road	414.1010	135/19
Days Inn Chester, (L-6)	2410 W. Hundred Road	748.5871	118/0
Days Inn Richmond, (H-3)	6910 Midlothian Turnpike	745.7100	114/1
Doubletree by Hilton Richmond-Midlothian, (G-2)	1021 Koger Center Blvd.	379.3800	237/9
Econo Lodge, (L-6)	2310 Indian Hills Road	520.1010	90/4
Econo Lodge Richmond South, (J-5)	2125 Willis Road	271.6031	48/0
Extended Stay America Arboretum, (H-2)	241 Arboretum Place	272.1800	0/123
Fairfield Inn by Marriott Chester, (L-5)	12400 Redwater Creek Road	778.7500	115/8
Four Points by Sheraton Richmond, (L-6)	9901 Midlothian Turnpike	323.1144	183/11
Hampton Inn Chester, (L-5)	12610 Chestnut Hill Road	768.8888	63/2
Hampton Inn Hull Street, (I-2)	3620 Price Club Blvd.	675.0000	68/6
Hampton Inn Midlothian Turnpike, (G-2)	800 Research Road	897.2800	80/5
Hampton Inn Richmond South/Bells Road, (H-5)	4300 Commerce Road	743.3550	104/0
Hilton Garden Inn Richmond South, (just South of L-6)	800 Southpark Blvd.	520.0600	155/10
Holiday Inn Express Brandermill, (J-1)	5030 W. Village Green Drive	744.7303	62/34
Holiday Inn Express Chester, (K-5)	1911 W. Hundred Road	751.0123	92/3
Holiday Inn Express Richmond Midlothian Turnpike, (G-3)	8710 Midlothian Turnpike	320.8900	144/0
Holiday Inn Richmond South Bells Road, (H-5)	4303 Commerce Road	592.2900	165/2
Homewood Suites by Hilton Richmond South, (L-6)	12810 Old Stage Road	751.0010	0/118
Hyatt Place Richmond Arboretum, (H-2)	201 Arboretum Place	560.1566	127/0
Hyatt Place Richmond Chester, (L-7)	13148 Kingston Ave.	530.4600	120/0
Interstate Inn, (just South of L-6)	2201 Indian Hills Road	526.4772	44/0
InTown Suites Richmond West, (G-1)	11551 Green Spring Road	897.7180	0/137
InTown Suites Richmond South, (K-5)	2601 Perdue Springs Drive	706.1999	0/120
La Quinta Inn & Suites, (G-1)	1301 Huguenot Road	794.4999	112/4
La Quinta Inn Richmond, (J-5)	9040 Pams Ave.	743.0770	50/13
Midlothian Inn	6523 Midlothian Turnpike	276.8241	72/0
Quality Inn Chester, (K-6)	12711 Old Stage Road	796.5200	45/26
Red Roof Inn Richmond South, (I-5)	4350 Commerce Road	271.7240	108/0
Regency Inn, (I-2)	10020 Hull Street Road	745.1900	25/1
Residence Inn by Marriott Richmond Chester, (L-7)	800 Bermuda Hundred Road	530.5501	0/136
Royal Inn, (I-2)	9801 Hull Street Road	276.4500	15/0
Sleep Inn & Suites Harbour Pointe, (J-1)	6451 Bayside Lane	639.3500	34/15
Sleep Inn South, (J-5)	2321 Willis Road	275.8800	51/0
Suburban Extended Stay, (K-5)	2401 W. Hundred Road	748.6321	165/0
Super 8 Motel Chester, (K-5)	2421 Southland Drive	748.0050	41/2
Super 8 Motel Hull Street, (I-2)	10300 Hull Street Road	276.3900	40/1
Super 8 Motel Midlothian, (G-2)	8260 Midlothian Turnpike	320.2823	70/2
V.I.P. Inn, (J-5)	2301 Willis Road	271.6081	102/0

NAME (MAP COORDINATES)	ADDRESS	PHONE (AREA CODE 804)	ROOMS/SUITES
WEST END/INNSBROOK/SHORT PUMP			
aloft Richmond West, (C-1)	3939 Duckling Drive	433.1888	135/0
Baymont Inn & Suites, (D-3)	7201 W. Broad St.	672.1108	120/1
Best Western Executive Hotel, (D-3)	7007 W. Broad St.	672.7007	114/2
Candlewood Suites Richmond West/Short Pump, (C-1)	4120 Brookriver Drive	364.2000	0/122
Comfort Inn & Conference Center, (E-4)	3200 W. Broad St.	359.4061	189/6
Comfort Suites Hotel Innsbrook, (C-2)	4051 Innslake Drive	217.9200	0/125
Country Inn & Suites by Carlson Richmond West, (D-3)	8010 W. Broad St.	755.6605	50/21
Courtyard by Marriott Northwest, (C-2)	3950 Westerre Parkway	346.5427	154/8
Courtyard by Marriott Richmond West, (E-3)	6400 W. Broad St.	282.1881	145/13
Days Inn West Broad, (E-3)	2100 Dickens Road	282.3300	178/0
Econo Lodge, (D-3)	7300 W. Broad St.	672.8621	61/0
Embassy Suites Hotel & Richmond Commerce Center by Hilton, (D-3)	2925 Emerywood Parkway	672.8585	0/224
Extended Stay America Glenside North, (D-3)	6807 Paragon Place	285.7050	82/0
Extended Stay America Glenside South, (D-3)	6811 Paragon Place	285.2065	0/108
Extended Stay America I-64 West, (C-1)	10961 W. Broad St.	747.8898	0/142
Extended Stay America Richmond Innsbrook, (C-2)	10060 W. Broad St.	747.0840	89/3
Fairfield Inn & Suites Richmond Northwest, (C-2)	9937 Mayland Drive	545.4200	61/22
Hampton Inn & Suites Glenside, (D-3)	5406 Glenside Drive	756.1777	85/31
Hampton Inn Richmond West, (C-2)	10800 W. Broad St.	747.7777	136/0
Hilton Garden Inn Richmond/Innsbrook, (C-2)	4050 Cox Road	521.2900	145/10
Hilton Richmond Hotel & Spa Short Pump, (C-1)	12042 W. Broad St.	364.3600	254/4
Holiday Inn Express Innsbrook, (C-2)	9933 Mayland Drive	934.9300	113/0
Holiday Inn I-64 & West End, (E-4)	2000 Staples Mill Road	359.6061	142/5
Homewood Suites by Hilton Richmond West, (C-2)	4100 Innslake Drive	217.8000	0/123
Hyatt House Richmond West, (C-1)	11800 W. Broad St.	360.7021	0/134
Hyatt Place Richmond Innsbrook, (C-1)	4100 Cox Road	747.9644	0/124
Quality Inn West End, (D-3)	8008 W. Broad St.	346.0000	188/0
Regency Inn	1500 Eastridge Road	285.9061	105/1
Residence Inn by Marriott Richmond Northwest, (C-2)	3940 Westerre Parkway	762.9852	0/104
Residence Inn by Marriott Richmond West, (E-3)	2121 Dickens Road	285.8200	0/80
Richmond Marriott Short Pump, (C-1)	4240 Dominion Blvd.	965.9500	243/9
Rodeway Inn, (D-3)	7300 W. Broad St.	726.9970	56/0
Speco Hotels of Richmond & Convention Center, (E-3)	6531 W. Broad St.	977.6440	280/10
SpringHill Suites by Marriott Richmond Northwest, (C-2)	9960 Independence Park Drive	217.7075	0/103
Suburban Extended Stay Hotel North West, (D-3)	7831 Shrader Road	273.6100	0/142
Super 8 Motel Broad Street, (D-3)	7200 W. Broad St.	672.8128	45/0
Towne Place Suites by Marriott Glen Allen, (C-2)	4231 Park Place Court	747.5253	0/95
The Westin Richmond, (E-3)	6631 W. Broad St.	282.8444	250/11
Wingate by Wyndham, (C-1)	13991 N. Gayton Road	421.1600	90/12



PLAN YOUR NEXT EVENT WITH US.

A GREAT hotel where service is everything. Let us help you make your next event or meeting a complete success while you sit back and enjoy the amenities of our Marriott.

MARRIOTT RICHMOND SHORT PUMP

4240 Dominion Boulevard
Glen Allen, Virginia 23060
Phone 804.965.9500
www.marriott.com/ricmw

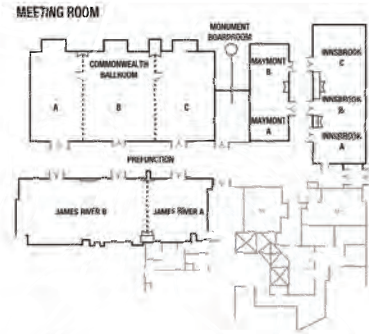

TRAVEL BRILLIANTLY

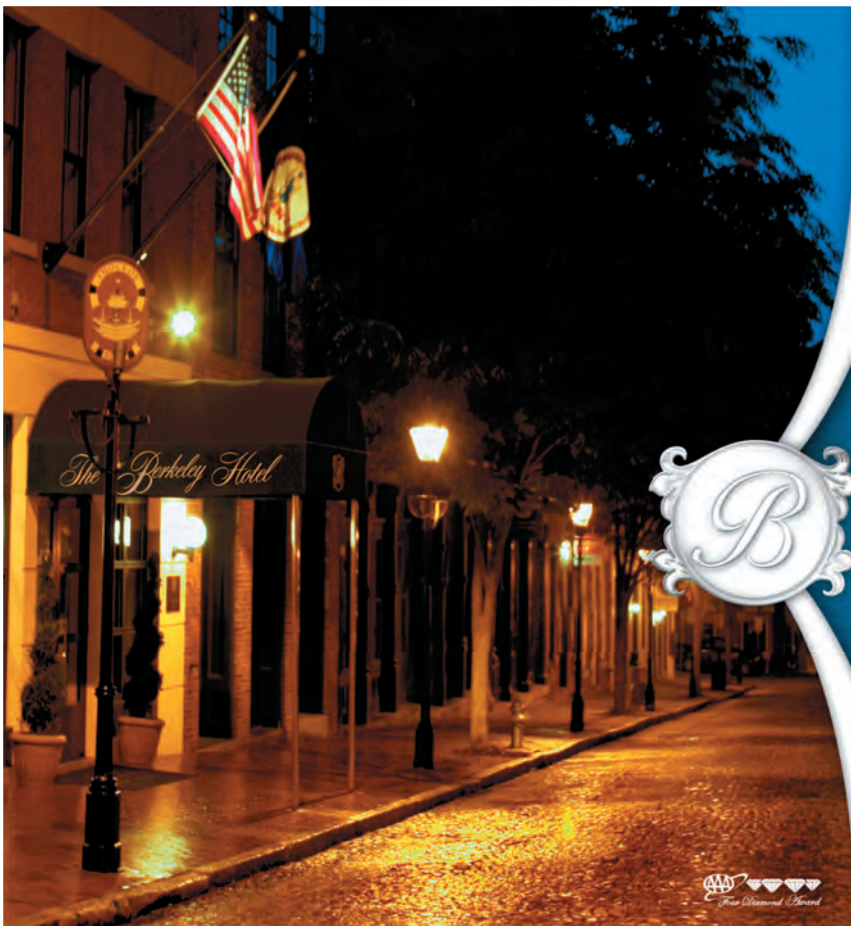

ONCE YOU CHOOSE, THE REST IS EASY

Spacious meeting rooms, customized menus, elegant appointments, and a Shockoe Slip address just steps from Richmond's capital and downtown area. Choose the Christopher Newport Ballroom or the Jamestown Room and let us do the rest. You're always welcome at The Berkeley Hotel.



The Berkeley Hotel

TO BOOK YOUR
NEXT MEETING,

CONTACT

804.225.5149

OR VISIT

berkeleyhotel.com

1200 E. CARY ST. RICHMOND, VA 23219





Richmond Region Attractions Map

- ★ Visitor Center
- 🚶 Walking Tour
- 🚲 Segway Tour
- 🌊 Water Attraction
- 🚶 Interpretive Walk
- 🚶 Multiuse Trail
- 🚶 Richmond Liberty Trail
- 🚶 Richmond Slave Trail
- James River Flood Wall

SCALE IN FEET

0 1000 2000





BE A PART OF HISTORY when you book your next meeting in Richmond.

Formerly the historic Miller & Rhoads department store building, the new Hilton Richmond Downtown combines the glorious past with every conceivable modern amenity. Just across the street from the Convention Center, this hotel property has everything you need for a successful and productive meeting, including complimentary Wi-Fi and a 24-hour business center, and over 15,000 sq. ft. of flexible meeting space to accommodate up to 750 guests. The new Hilton Richmond Downtown. Your place in history. **Everything. Right where you need it.®**



501 East Broad St.
Richmond, VA 23219
804-344-4300

Reservations: richmonddowntown.hilton.com • 1-800-774-1500

©2009 Hilton Hotels Corporation

The Cultural Arts Center *At Glen Allen*



- ♦ CAN ACCOMMODATE 3 TO 350 PEOPLE
- ♦ BEAUTIFULLY APPOINTED MEETING SPACES
& 350-SEAT THEATRE
- ♦ FREE, CONVENIENT PARKING
- ♦ TEAM BUILDING OPPORTUNITIES

FOR MORE INFORMATION OR TO ARRANGE A TOUR, CONTACT:
Holly Marshall, CMP - Events Manager
(804) 261-6211 | rentals@artsglenallen.com
WWW.ARTSGLENALLEN.COM

2880 MOUNTAIN ROAD, GLEN ALLEN, VA 23060



An Extraordinary Location.

Your place to innovate, communicate and celebrate. Leave the "bored" room for some inspired brainstorming. Entertain clients amidst giant aquariums. Or host an elegant celebration steps away from historic gardens. Experience the endless possibilities at Maymont.

804-358-7167 | maymont.org

MAYMONT®



LINDEN ROW
A GREAT AMERICAN INN

Boutique Historic Hotel – Downtown Richmond

100 East Franklin Street
Richmond, Virginia 23219
www.lindenrowinn.com



To book a meeting, event, or guest accommodations with us,
please contact our
Group Sales and Events Office
1.804.225.5841
sales@lindenrowinn.com

The Hilton Richmond Hotel & Spa

- ♦ Seasoned sales professionals to manage every detail of your event
- ♦ Exquisite Capital pre-function area
- ♦ Capital ballroom seating up to 850 and 1,000 reception
- ♦ Customized Welcome Amenities
- ♦ 254 Beautifully appointed guests & suites
- ♦ Executive & junior suites available
- ♦ Complimentary wireless internet in guest rooms
- ♦ Free parking & shuttle service
- ♦ Indoor pool & wirlpool & exercise room
- ♦ Relax and rejuvenate in Aura Spa & Salon, located inside the Hilton
- ♦ Visit Shula's Steak House & Lounge... enjoy our daily specials or relax with friends after your meeting



Located in the heart of Short Pump

12042 West Broad Street

Richmond VA 23233

804.364.3600



MEETINGS SIMPLIFIED.

Homewood Suites and Hampton Inn & Suites Richmond Downtown is located in the heart of downtown Richmond, steps from the Virginia State Capitol, Federal Courthouse, Richmond Coliseum, Richmond Convention Center, and a multitude of restaurants, entertainment, and shopping options. Come experience our oversized guestrooms and suites, which are 80% larger than traditional hotels; we give you the space you need to **work, live, and play.**

Our hotels have 244 rooms and 7,000 square feet of flexible meeting space perfect for your conferences, meetings, weddings, and other social events. Our space features a 2,840 square foot ballroom with windows for natural light. It can be split into three sections. Our hotels also offer an additional two 1,000 square foot meeting rooms, 2 executive boardrooms, and 8 additional small meeting rooms perfect for interviews, depositions, or a small dinner party.

700 East Main Street | Richmond, VA 23219



Hampton Inn & Suites Richmond Downtown
richmonddowntownsuites.hamptoninn.com
804-643-2500 | Fax: 804-643-5400



Homewood Suites Richmond Downtown
richmonddowntown.homewoodsuites.com
804-643-2900 | Fax: 804-643-5200



OMNI UNDERSTANDS

Charm

Located at the center of the city's financial district, the Omni Richmond Hotel overlooks the scenic James River and is just steps away from the Shockoe Slip dining and entertainment area. Ideal for business meetings and events, the hotel features 361 luxurious guest rooms and 15,000 square feet of function space, including the 7,027-square-foot James River Ballroom. It's the ultimate location for your next gathering.

804-344-7000 • omnihotels.com/richmond

OMNI  HOTELS
& RESORTS
richmond